

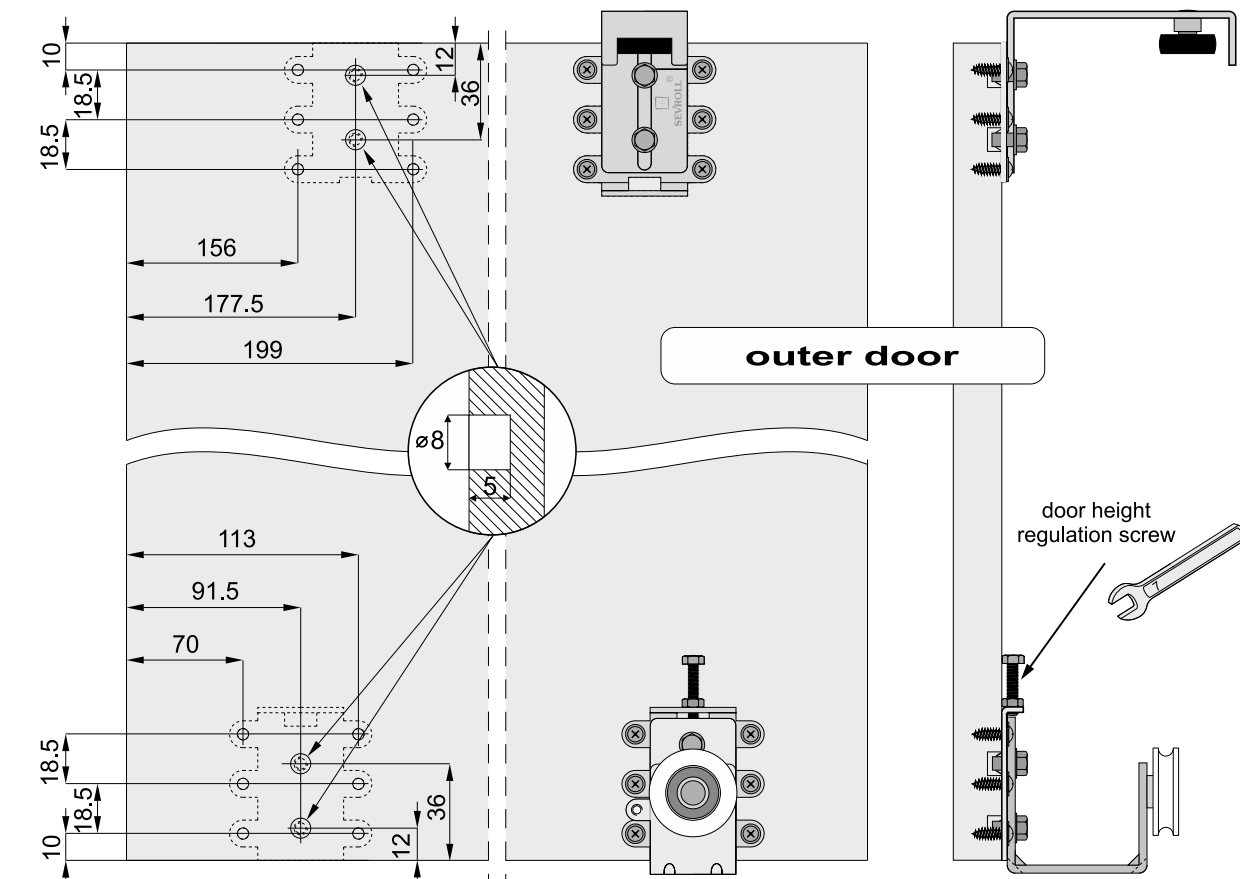

ATTENTION!

Included self-tapping metal screws for fixing carriages must be replaced with self-tapping woods screws **4x16** (Dome heads).
Not included in set.

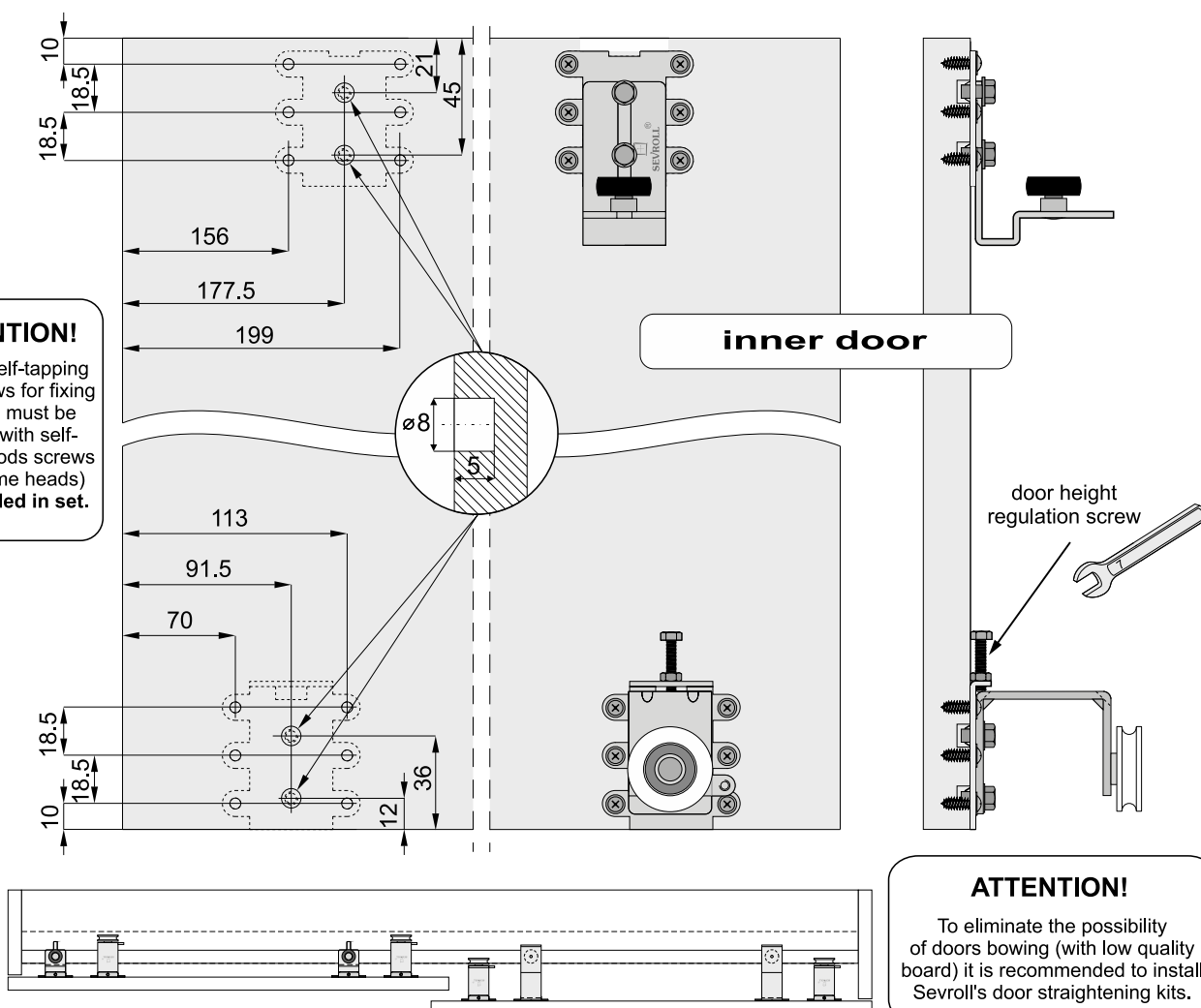



Inner door installation

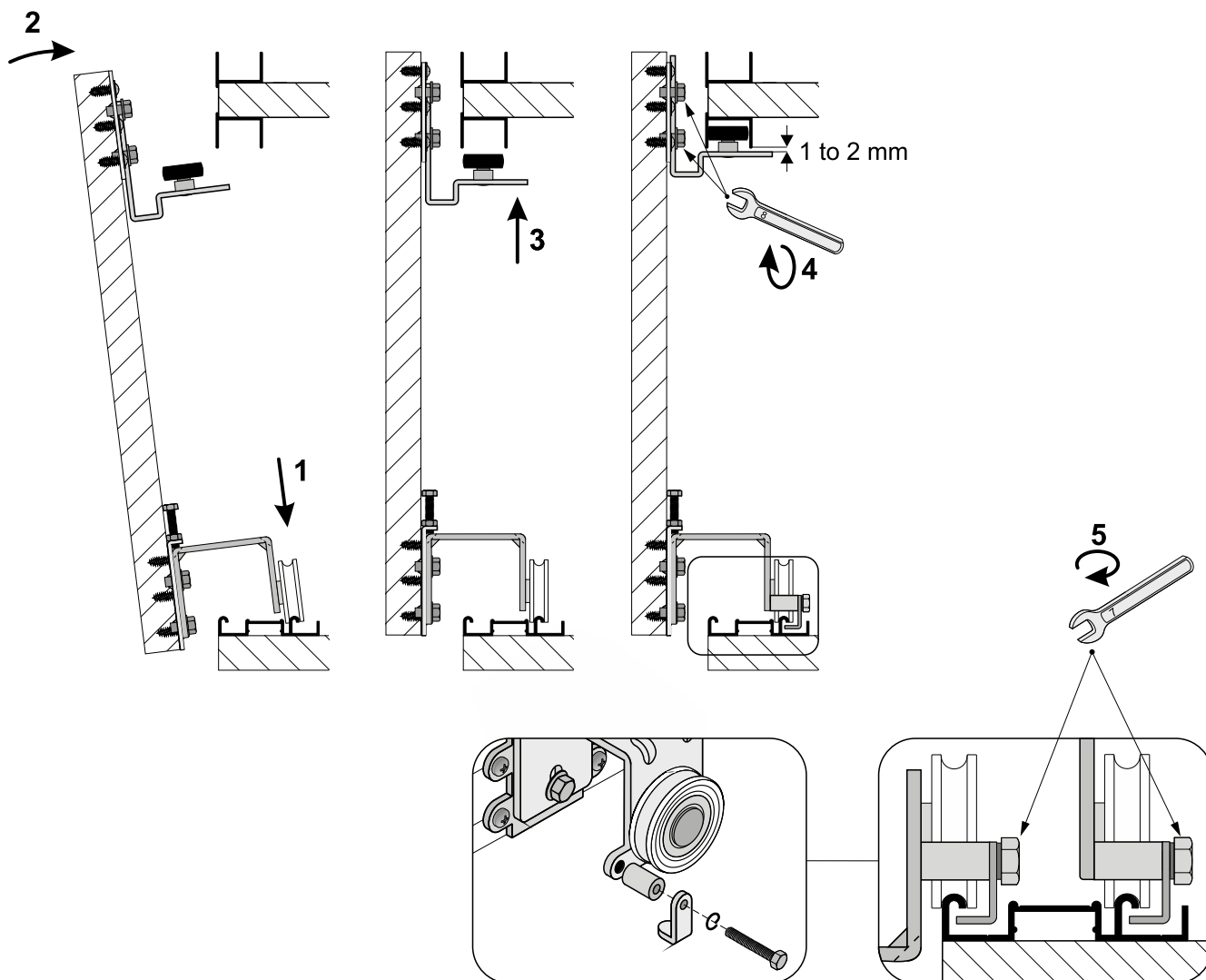

Outer door installation

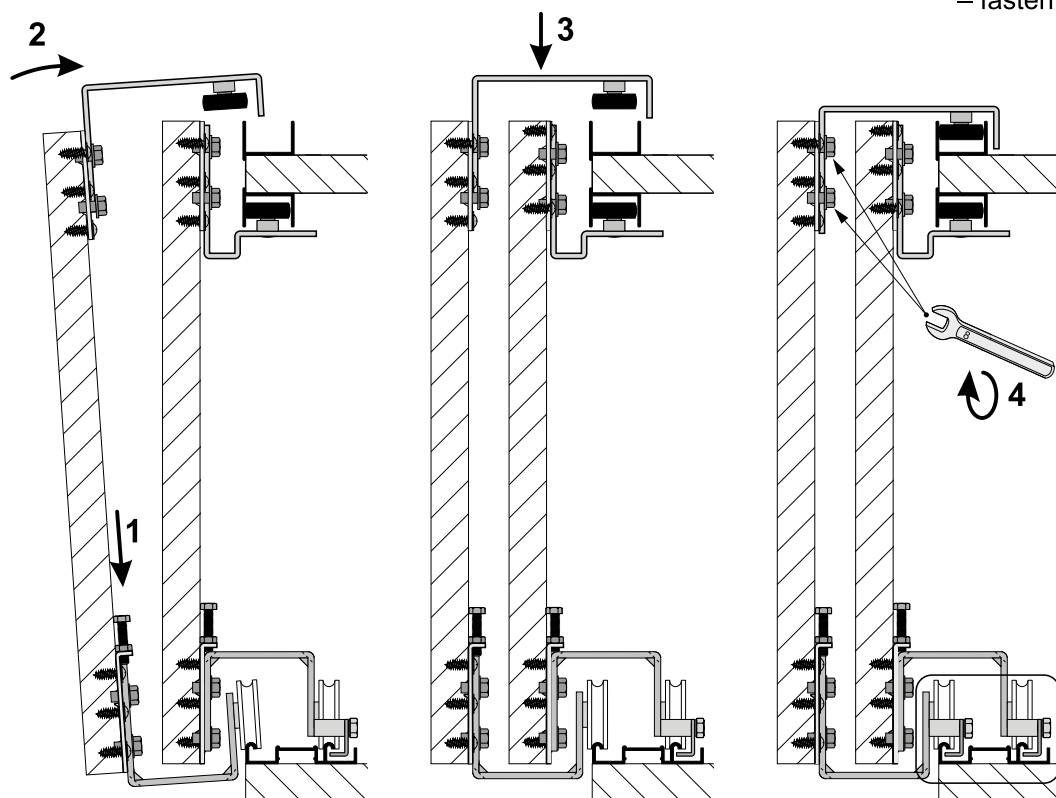

Soft-close installation

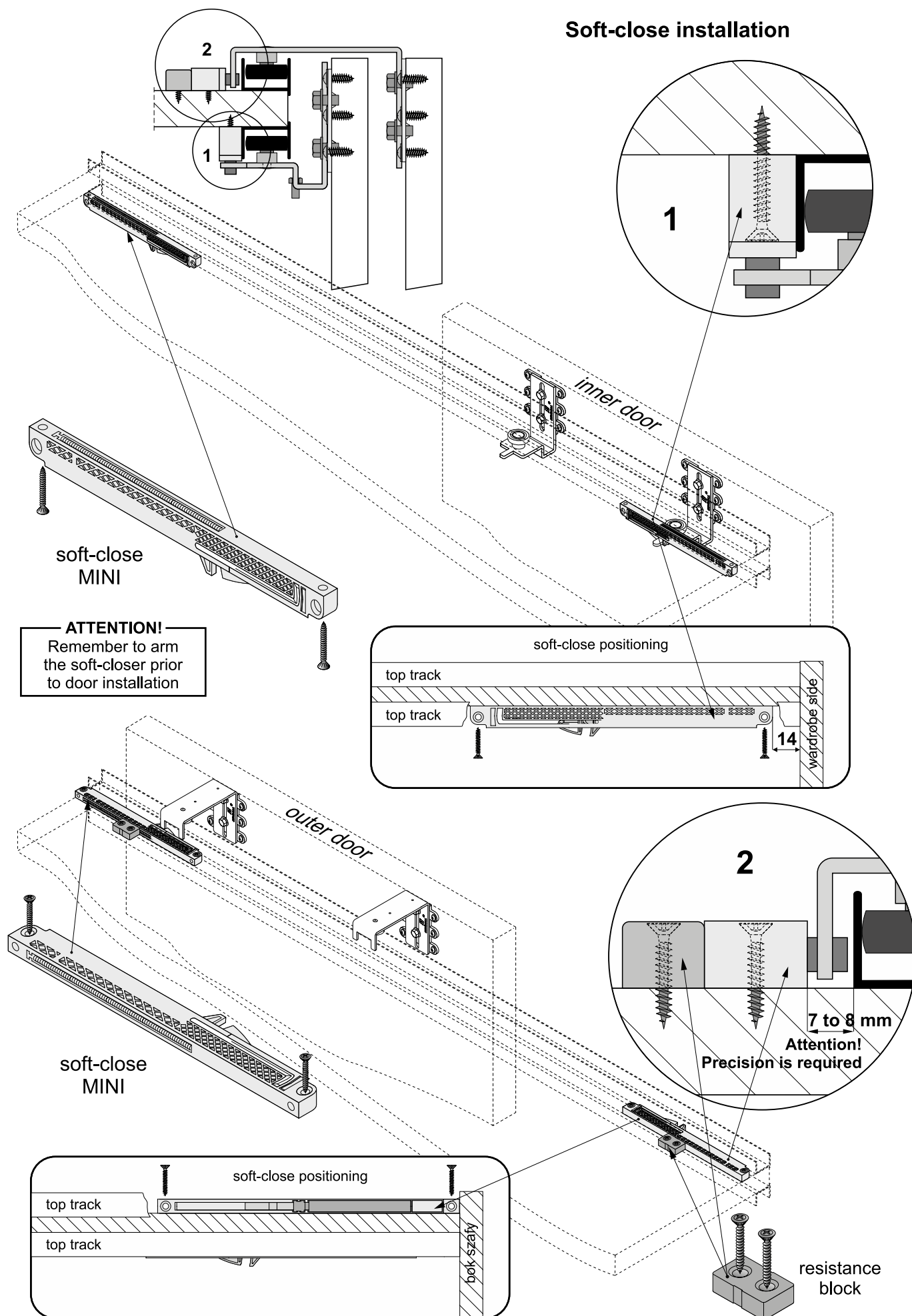



ATTENTION! With system **Eden Board** for use with **18 mm** board you can use handle profiles from our **Gemini 18** range.

Inner door/s - 1 handle

Outer door - 2 handles

(Door width calculations change)

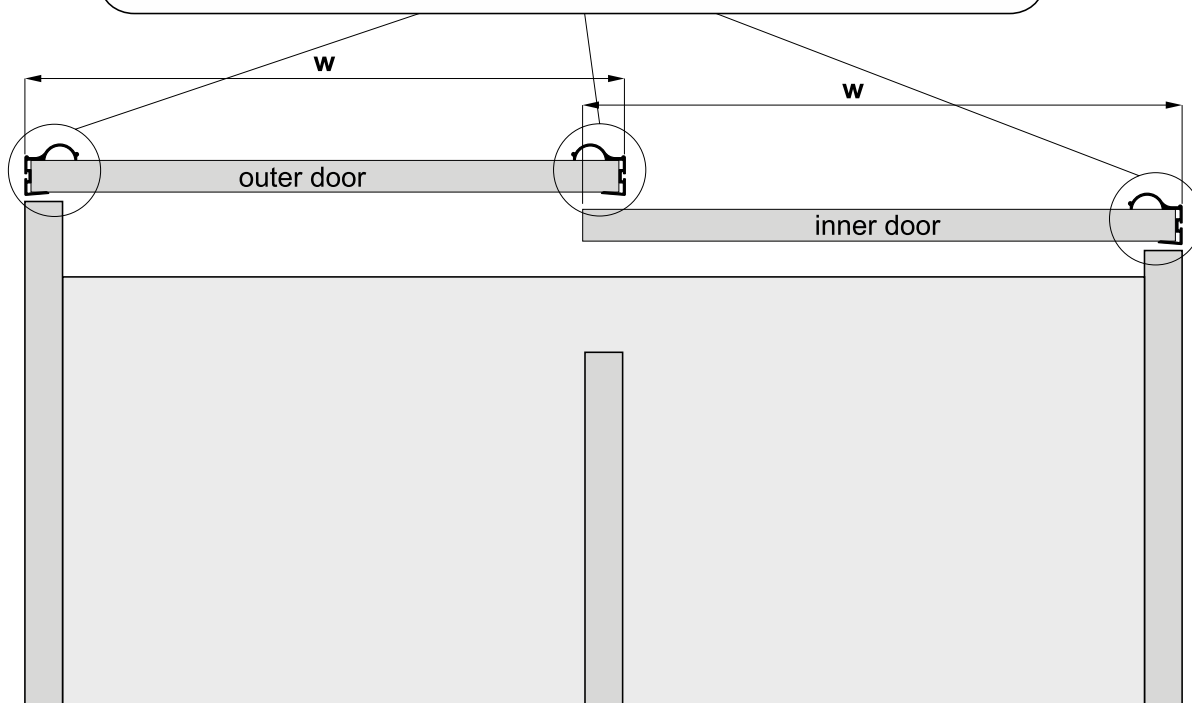

door width	- w	$w = (W + 36 \text{ mm}) : 2$
board width (outer door)	- wp_o	$wp_o = w - 2x$
board width (inner door)	- wp_i	$wp_i = w - x$

The value of **x** depends on the handle profile used

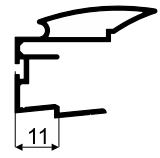
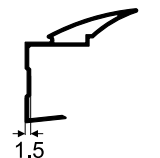
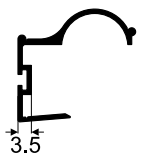
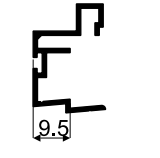
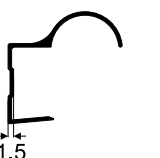
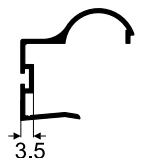
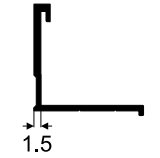
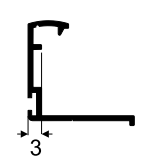
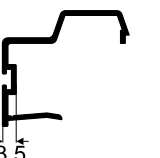
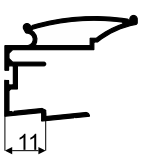
 Alfa $x = 11 \text{ mm}$	 Beta $x = 1.5 \text{ mm}$	 Factor $x = 3.5 \text{ mm}$	 Faworyt $x = 9.5 \text{ mm}$
 Focus $x = 1.5 \text{ mm}$	 Focus II $x = 3.5 \text{ mm}$	 Secret Line $x = 1.5 \text{ mm}$	 Slim Line $x = 3 \text{ mm}$
 Universal $x = 3.5 \text{ mm}$	 Victoria $x = 11 \text{ mm}$		

Carriage installation

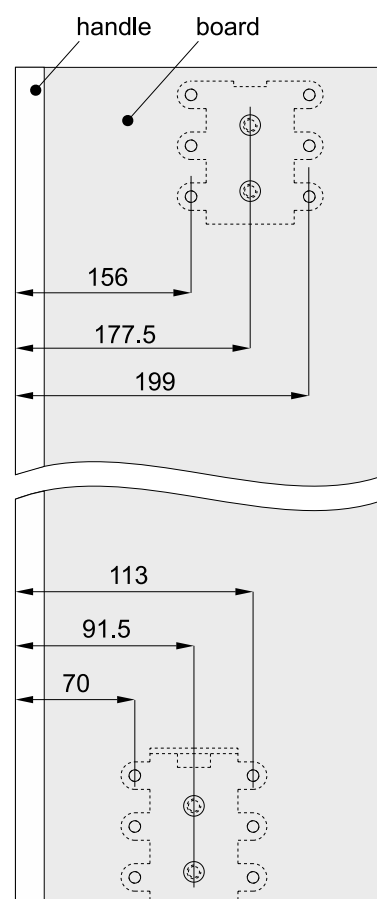

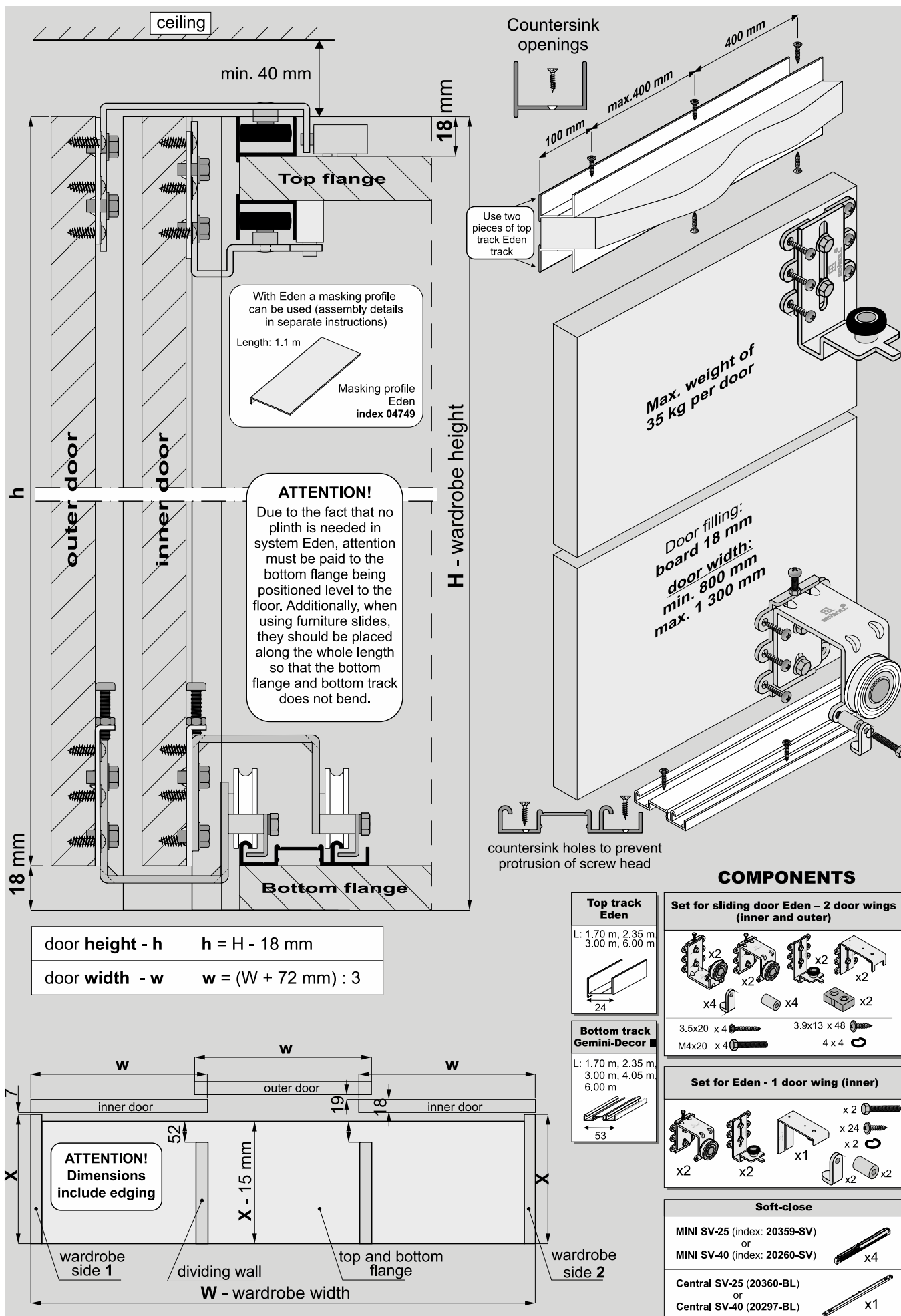

**ATTENTION!**

Included self-tapping metal screws for fixing carriages must be replaced with self-tapping wood screws **4x16** (Dome heads) **Not included in set.**

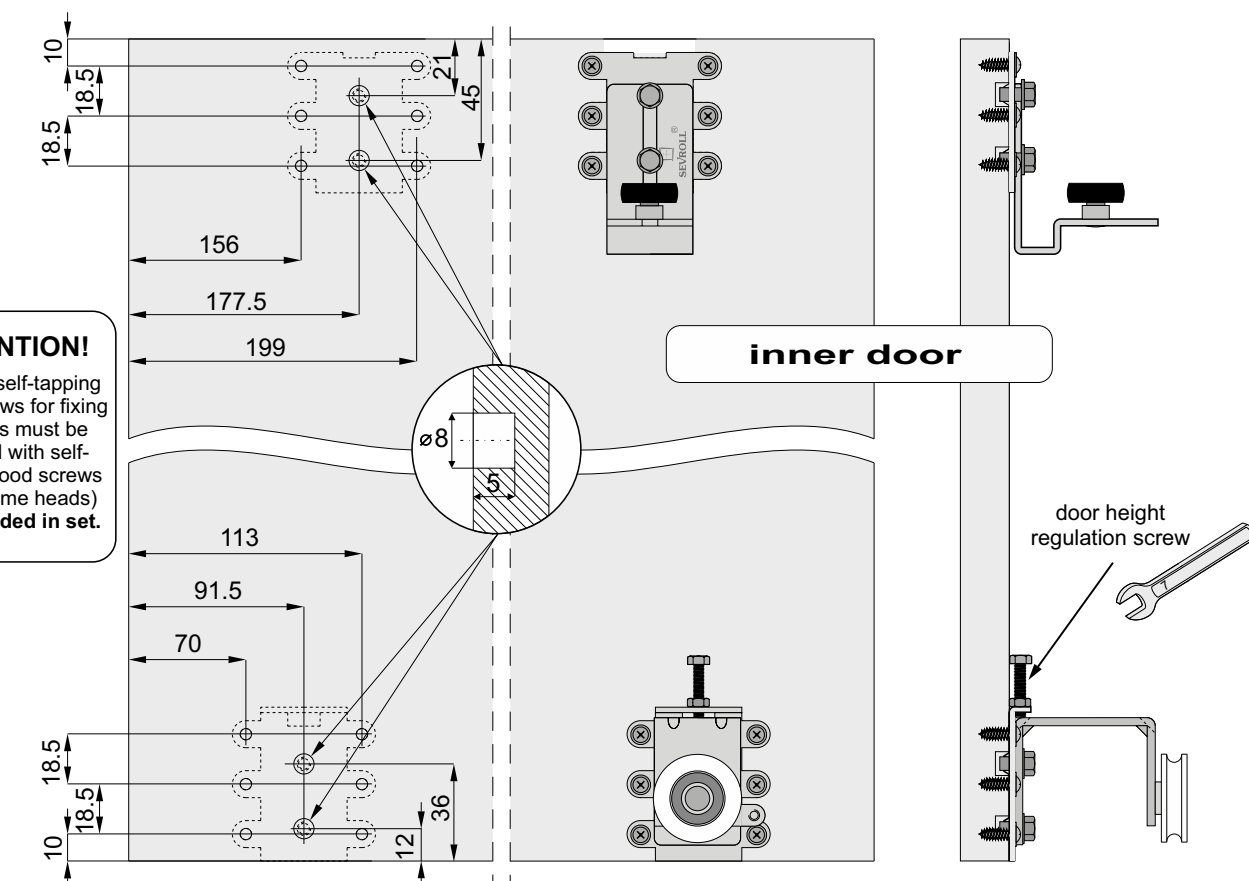
**ATTENTION!**

To eliminate the possibility of doors bowing (with low quality board) it is recommended to install Sevrill's door straightening kits.

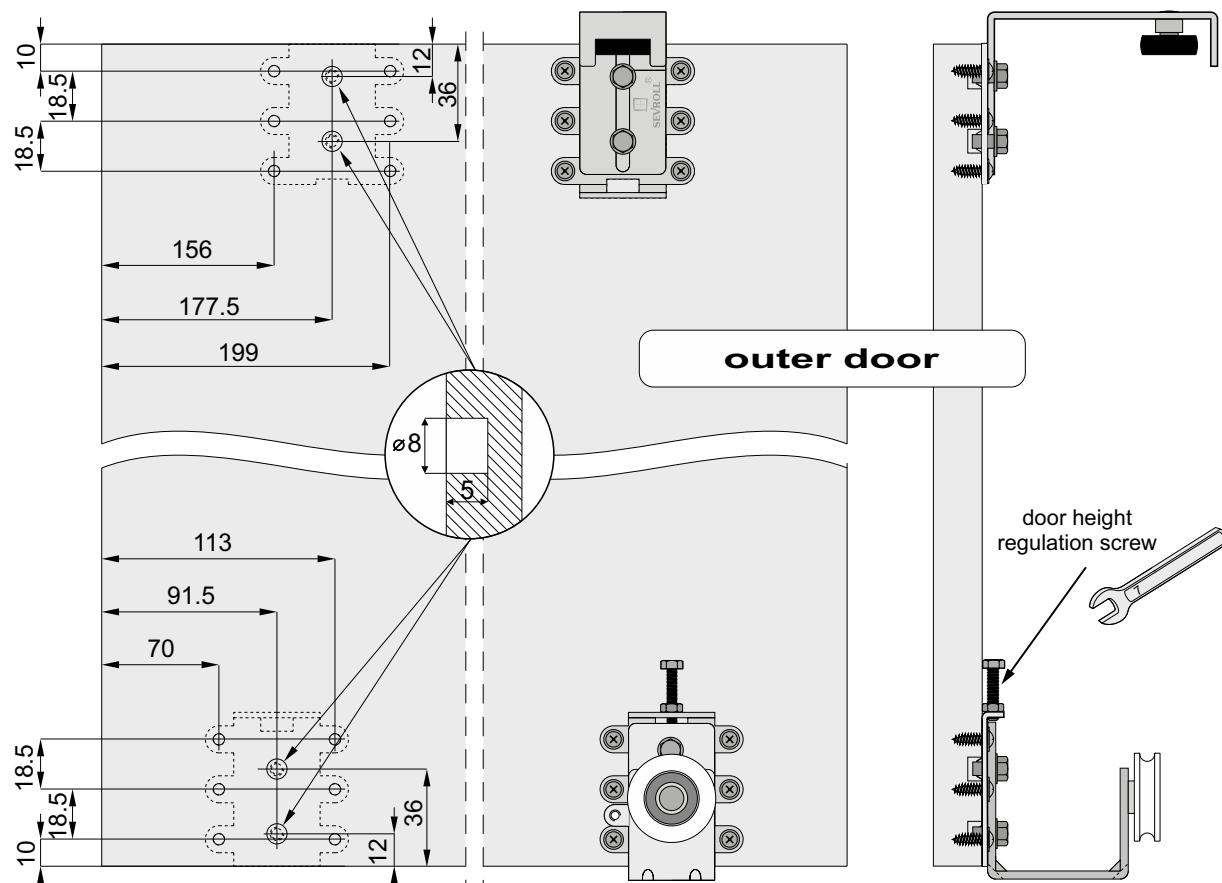
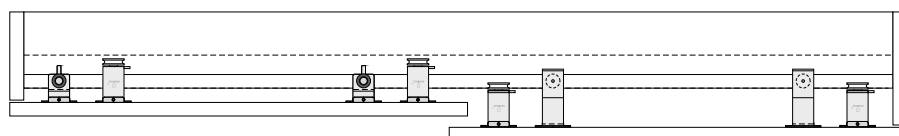

Inner door installation

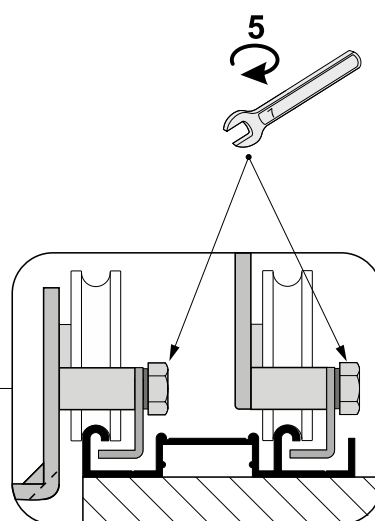
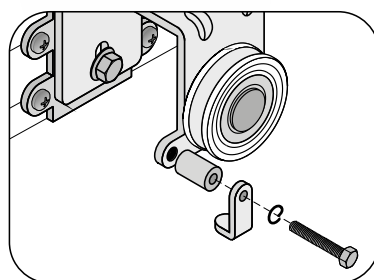
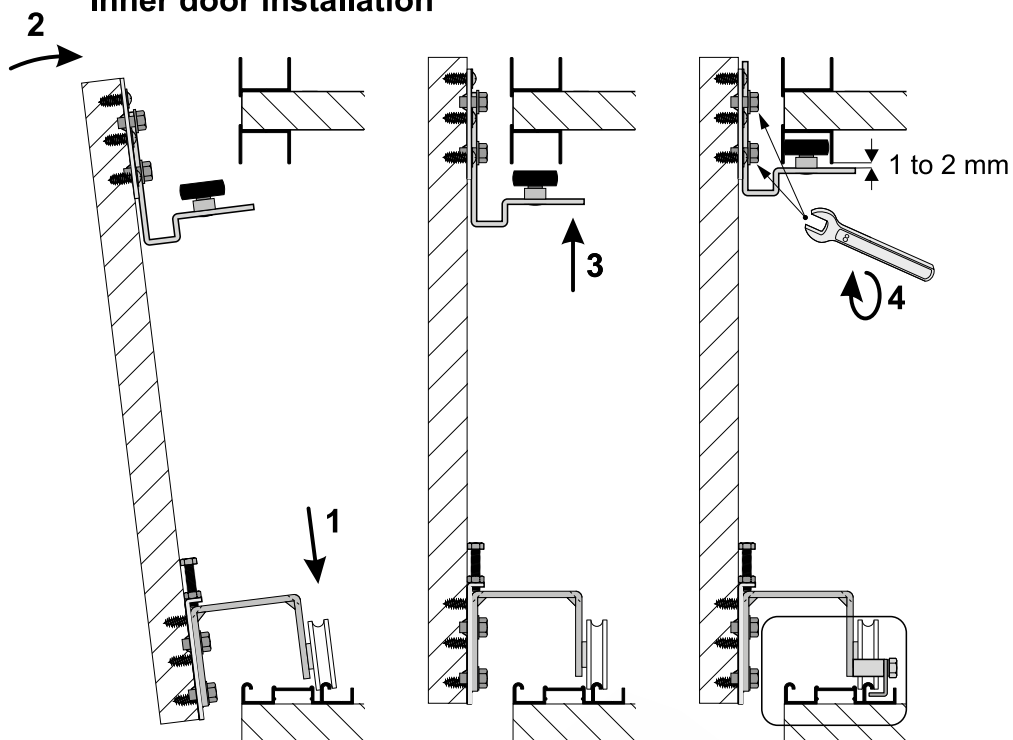

securing catch
– fasten after door assembly

Outer door installation

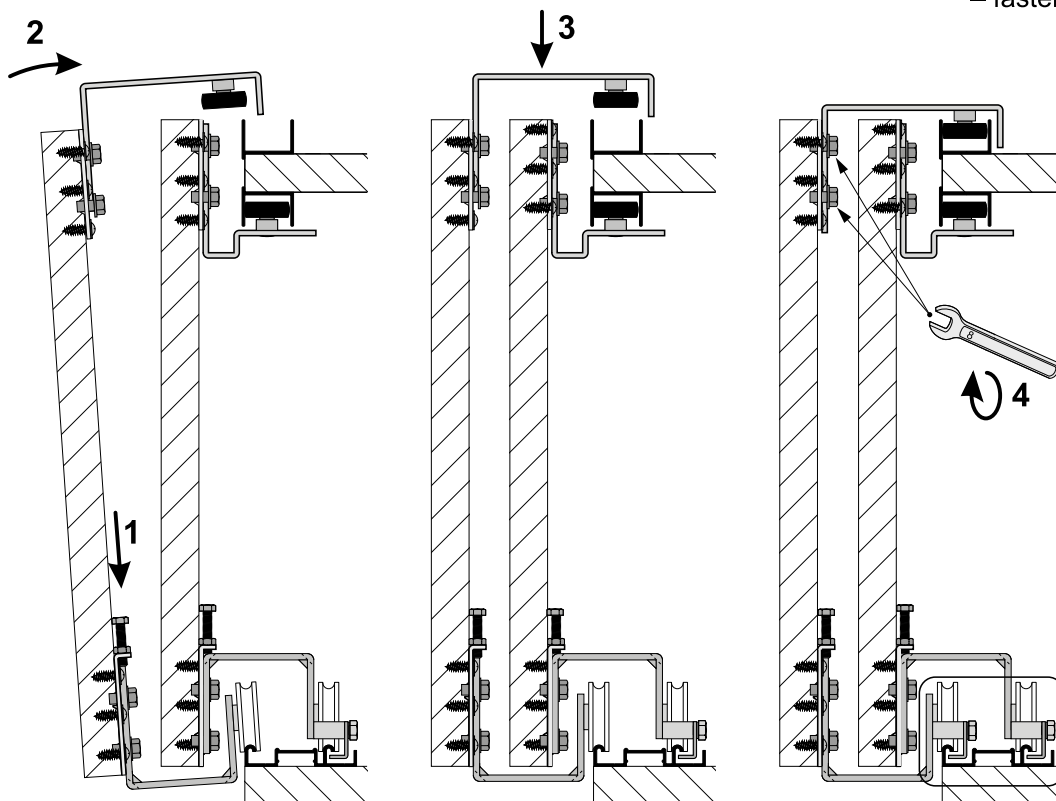



Soft-close installation

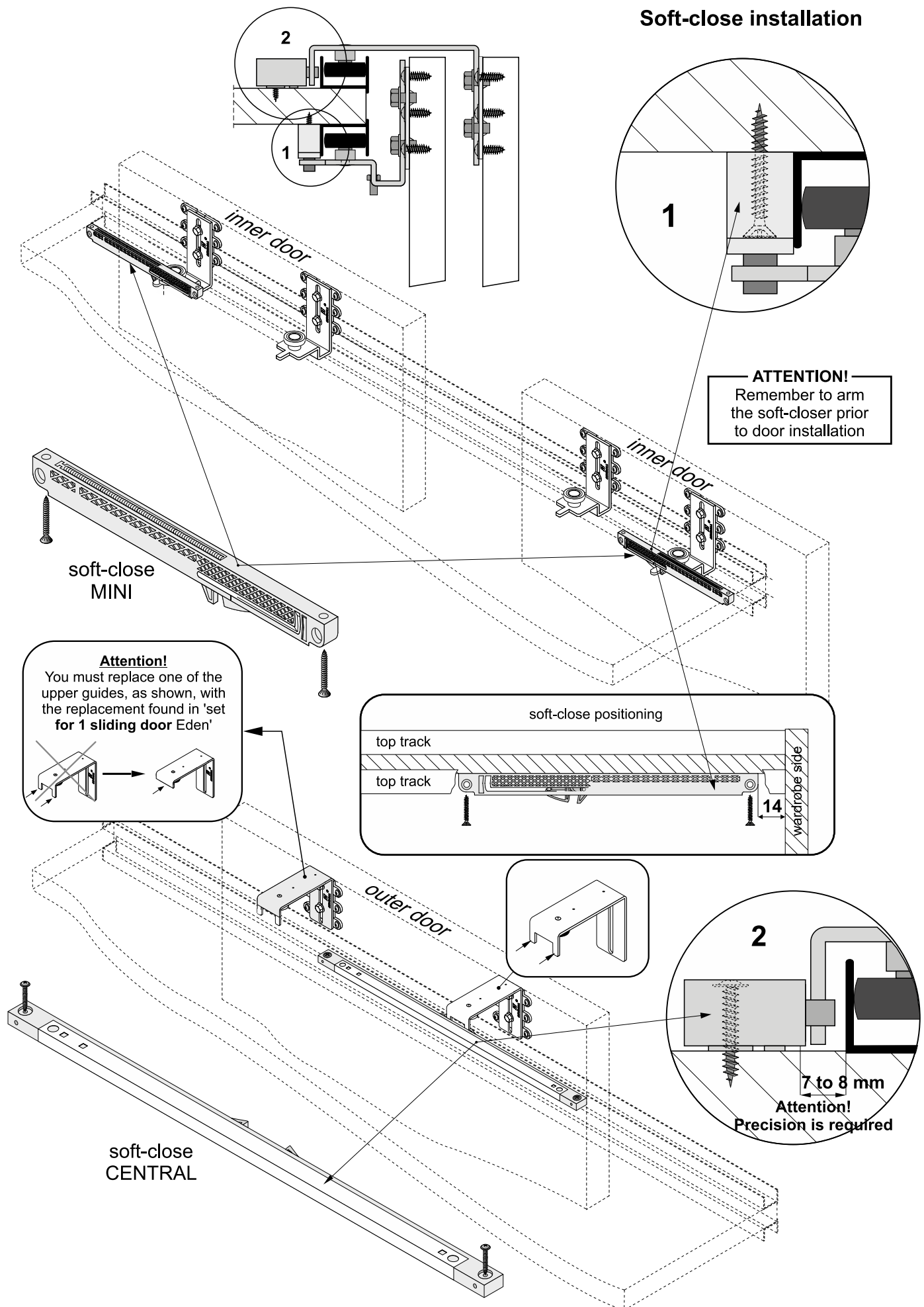



ATTENTION! With system **Eden Board** for use with **18 mm** board you can use handle profiles from our **Gemini 18** range.



Inner door/s - 1 handle

Outer door - 2 handles

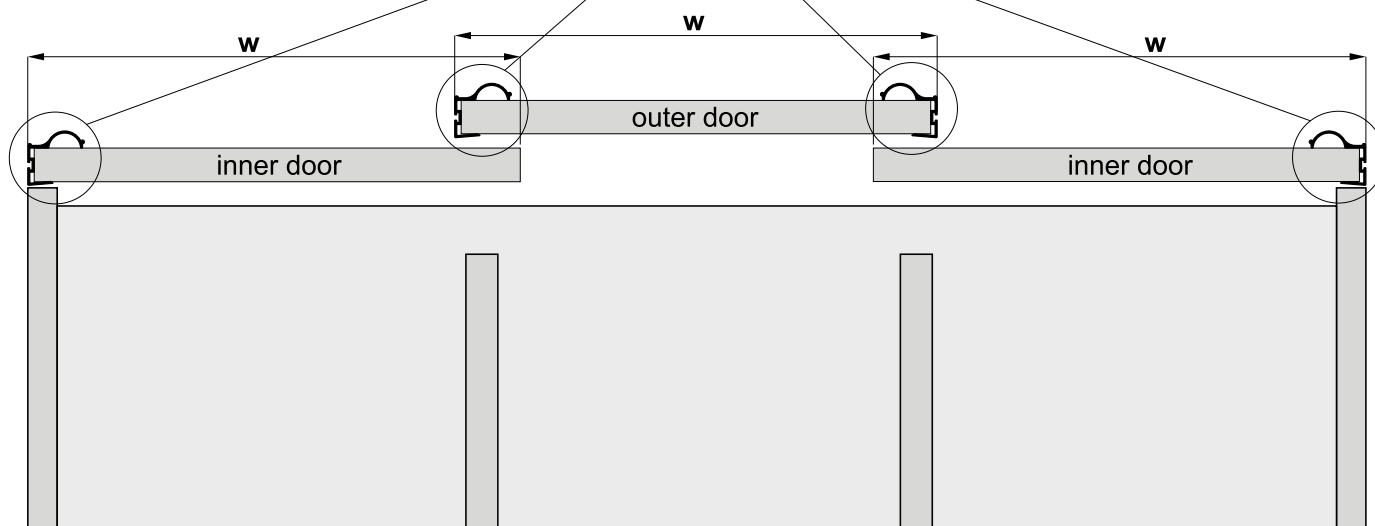
(Door width calculations change)

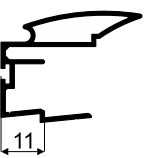
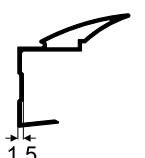
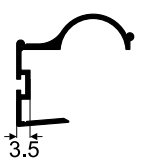
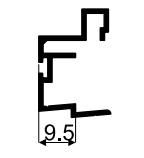
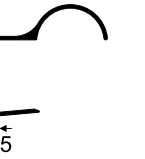
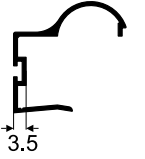
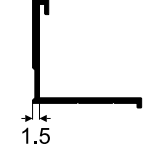
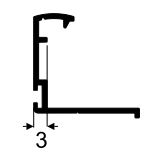
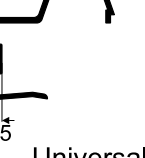

door width	- w	$w = (W + 72 \text{ mm}) : 3$
board width (outer door)	- wp_o	$wp_o = w - 2x$
board width (inner door)	- wp_i	$wp_i = w - x$

The value of x depends on the handle profile used			
 Alfa $x = 11 \text{ mm}$	 Beta $x = 1.5 \text{ mm}$	 Factor $x = 3.5 \text{ mm}$	 Faworyt $x = 9.5 \text{ mm}$
 Focus $x = 1.5 \text{ mm}$	 Focus II $x = 3.5 \text{ mm}$	 Secret Line $x = 1.5 \text{ mm}$	 Slim Line $x = 3 \text{ mm}$
 Universal $x = 3.5 \text{ mm}$	 Victoria $x = 11 \text{ mm}$		

Carriage installation

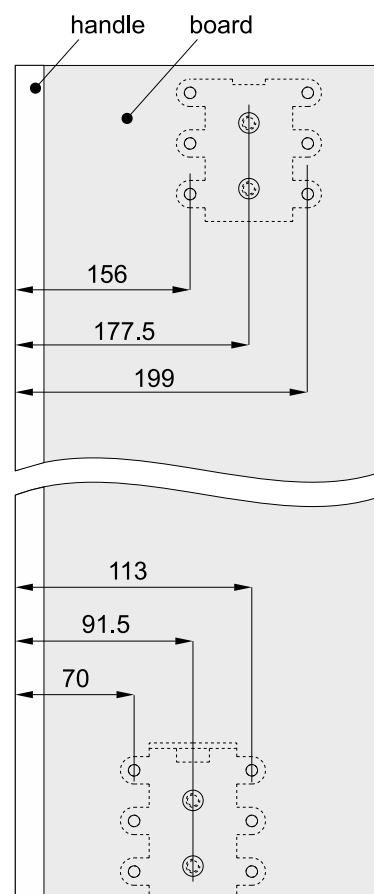



installation method for masking profile EDEN

