

COMPONENTS

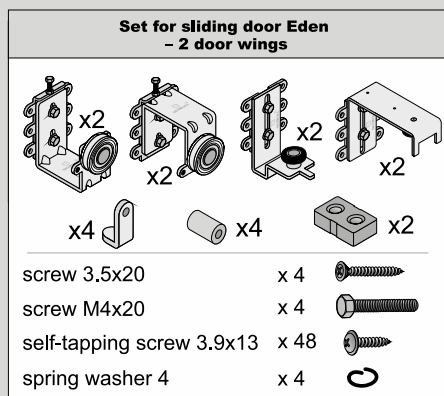

You must remember to purchase self-tapping screws to construct each door (min. 8 screws per door).

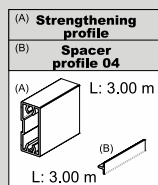
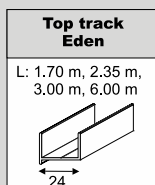
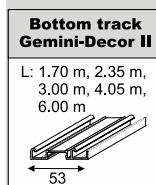
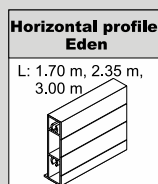
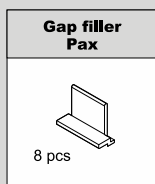
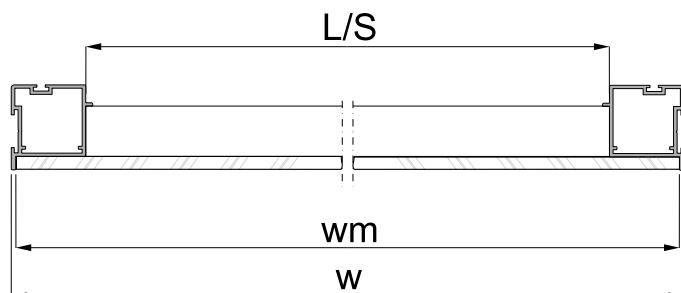
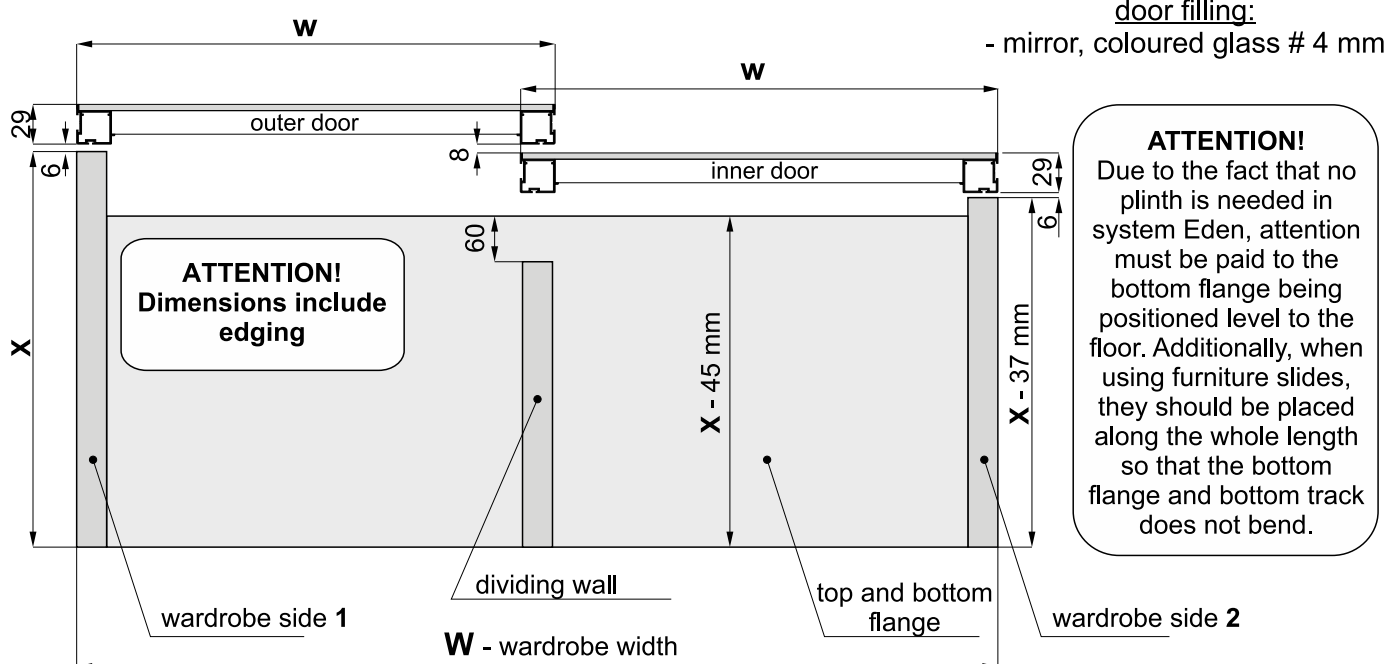

| | |
|------------------------------------|-------------------------------|
| Door width | $w = (W + 25 \text{ mm}) : 2$ |
| Mirror width | $w_m = w - 4 \text{ mm}$ |
| Horizontal profile Eden length - L | $L = S = w - 50 \text{ mm}$ |
| Strengthening profile length - S | |
| Spacer profile 04 length | $S + 46 \text{ mm}$ |

ATTENTION!

Rear mirror / coloured glass surface must be secured with safety backing foil (excluding glass surface glued with mirror adhesive).
The edges of glass must be polished.

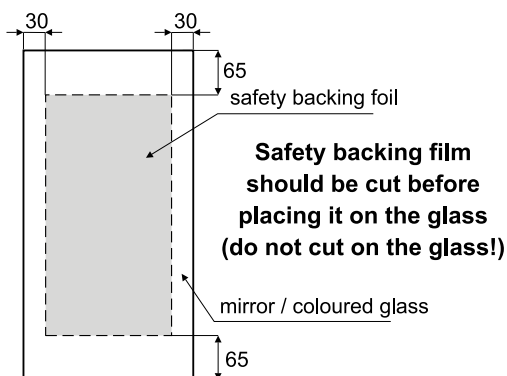

Installation method for fitting mirror or coloured glass 4 mm

- with horizontal profile
- with handle

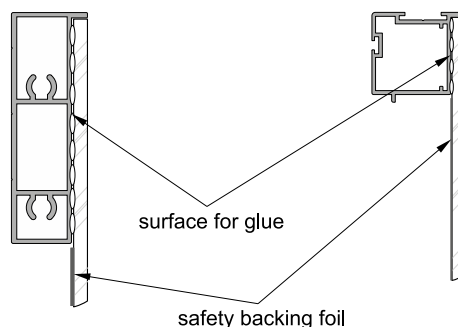

- with strengthening profile

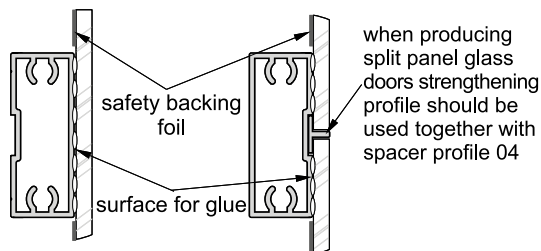

it is recommended that mirror / coloured glass is glued to aluminium profiles with specialist glass adhesive

The method of cutting spacer profile 04

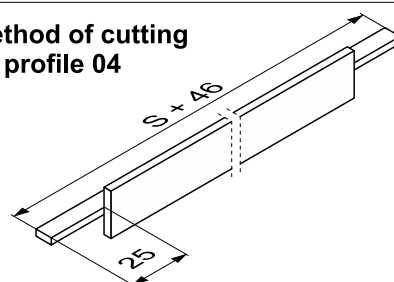



openings $\varnothing 3$
for fastening
carriages must
be drilled along
profile grooves

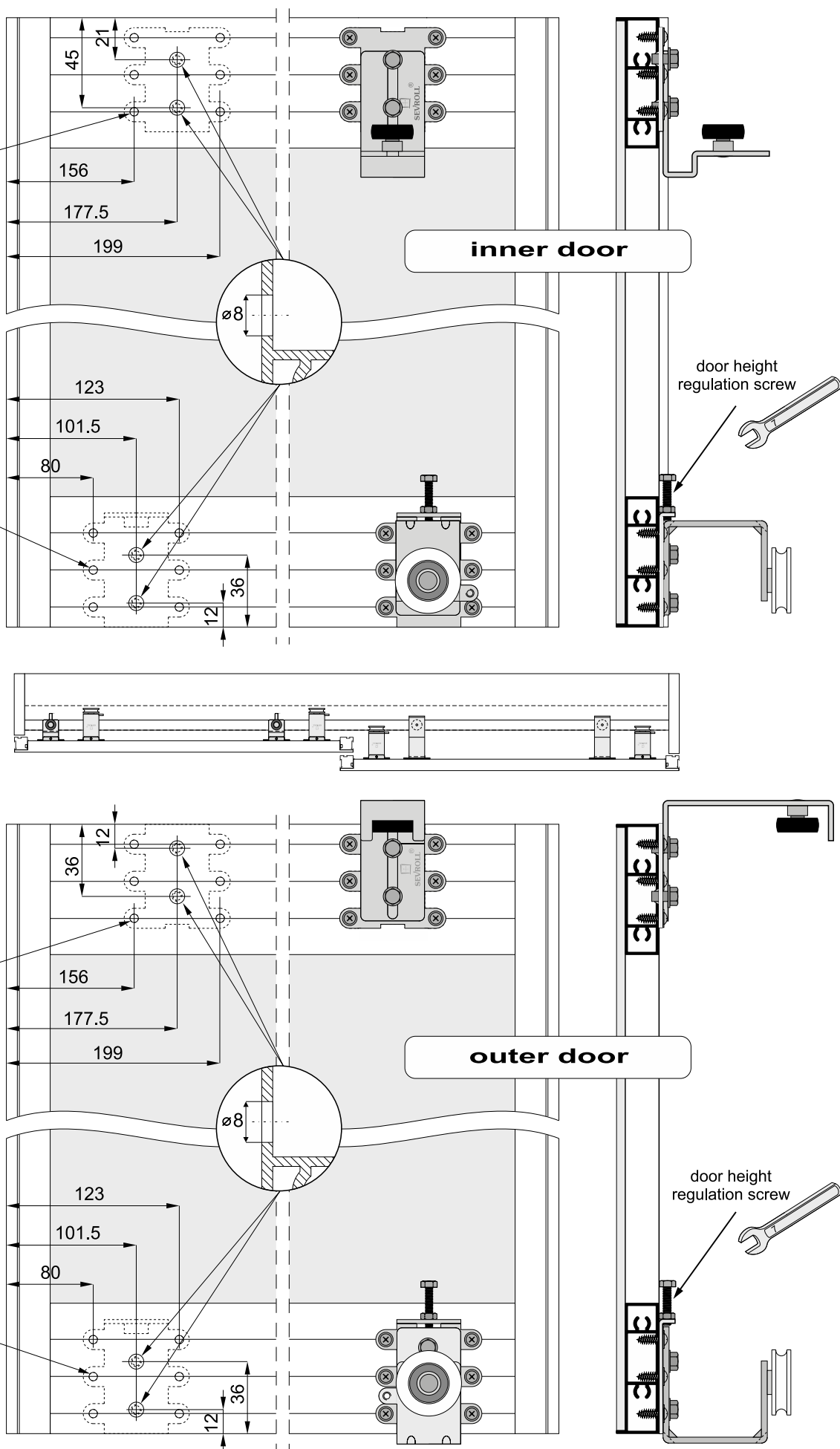
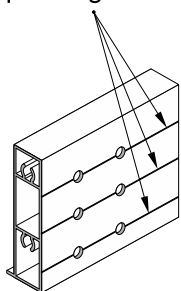



Inner door installation

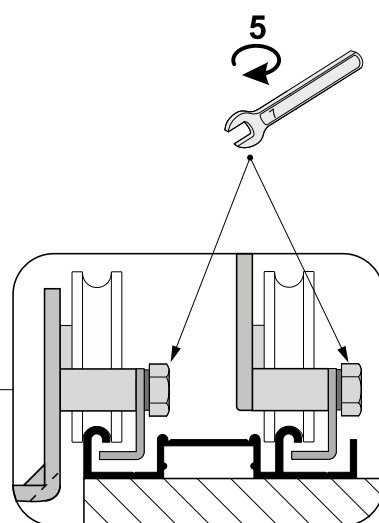
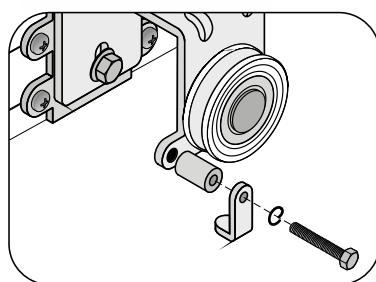
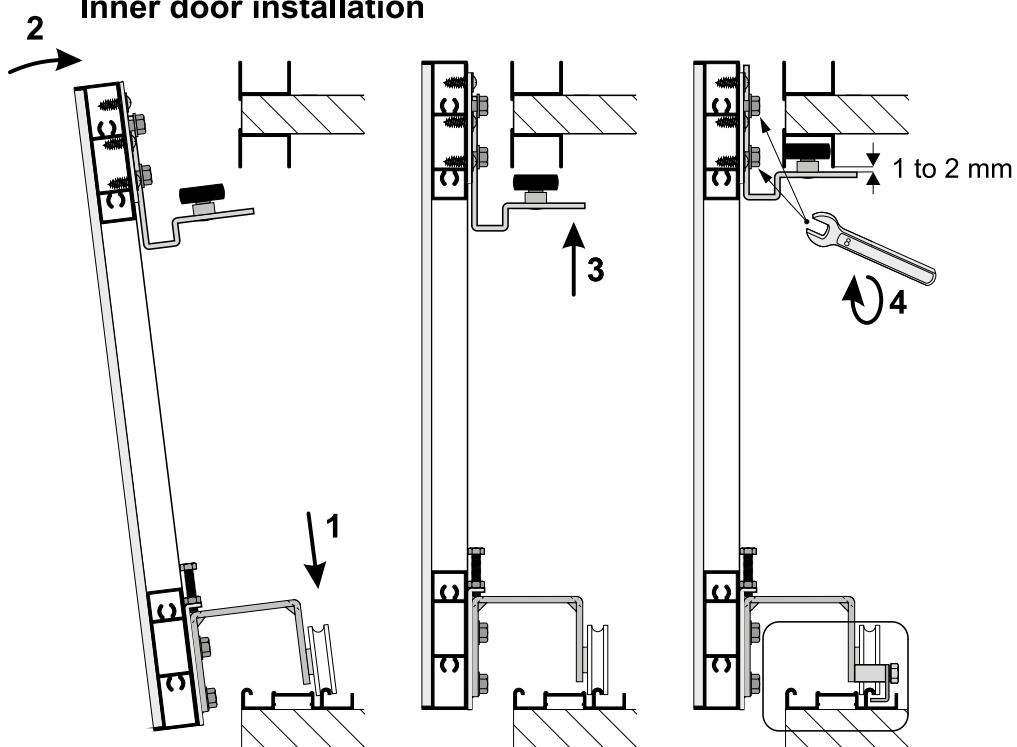

securing catch
- fasten after door assembly

Outer door installation

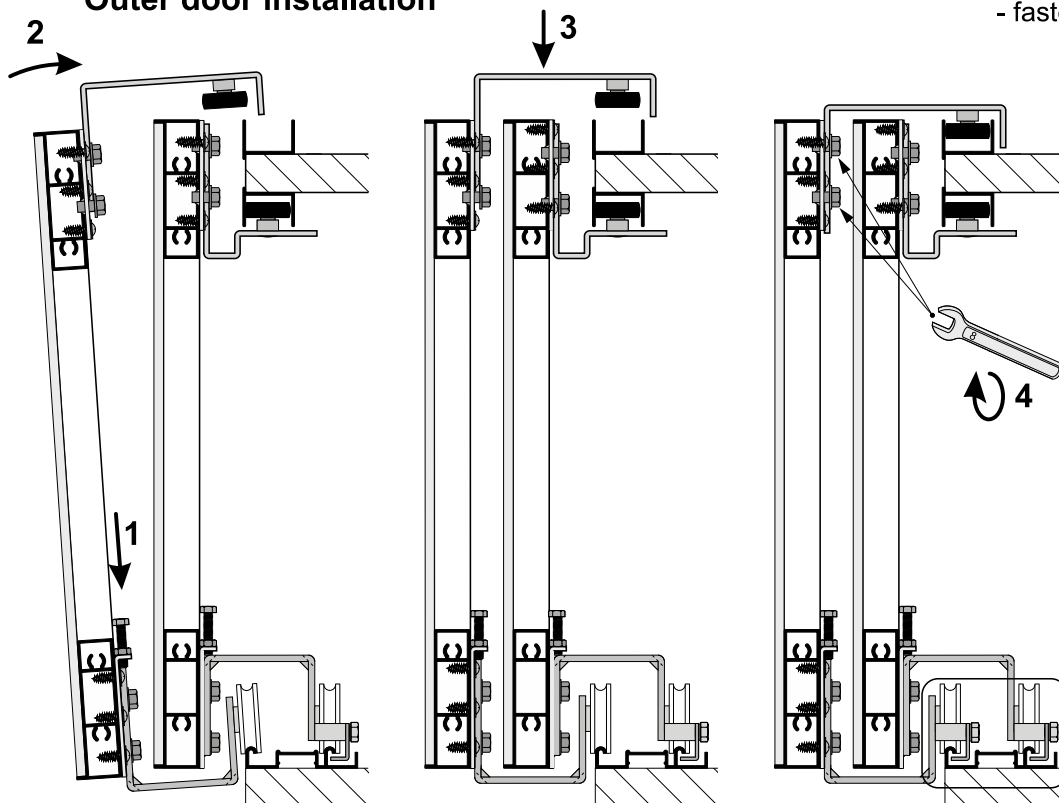



Soft-close installation

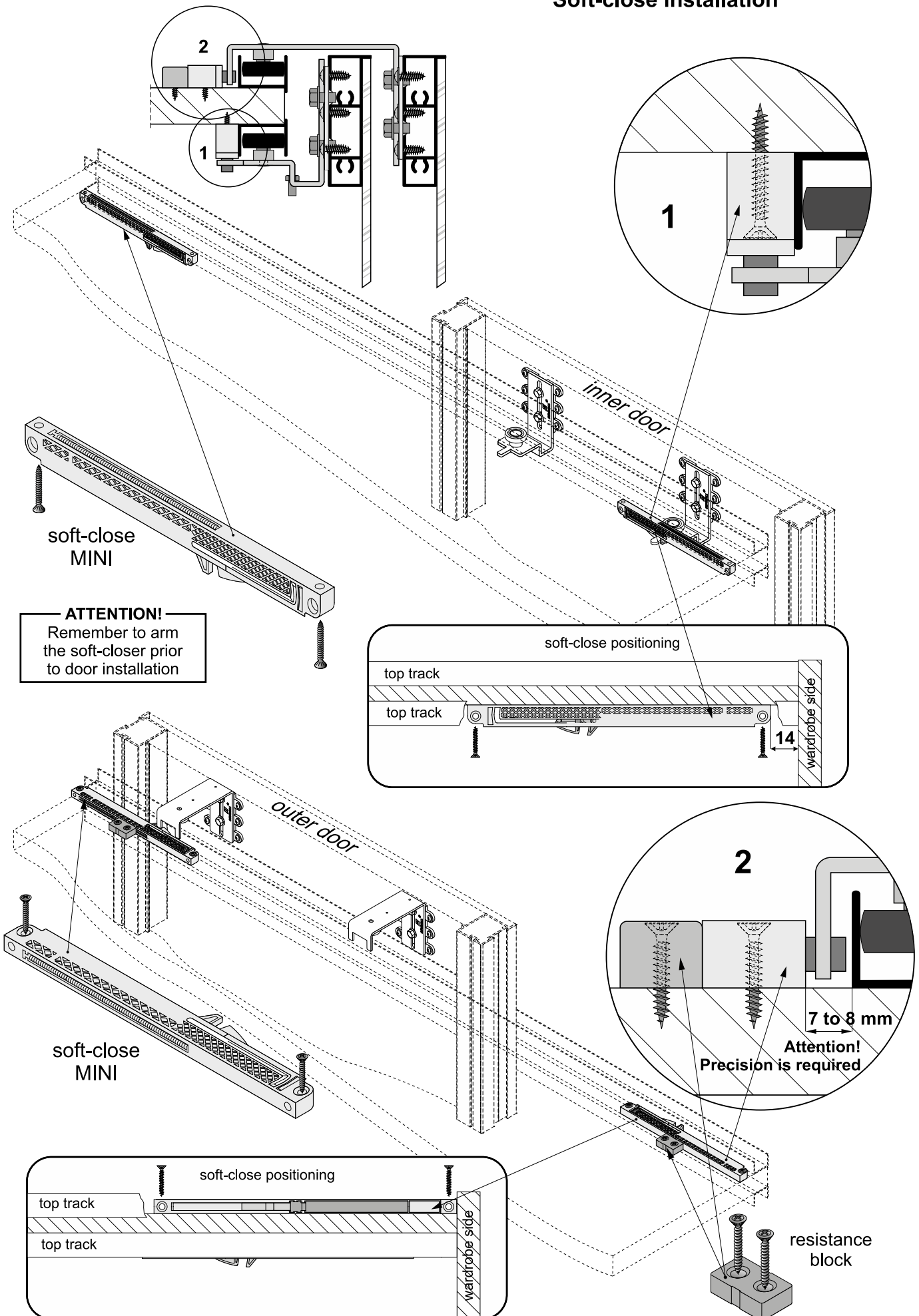

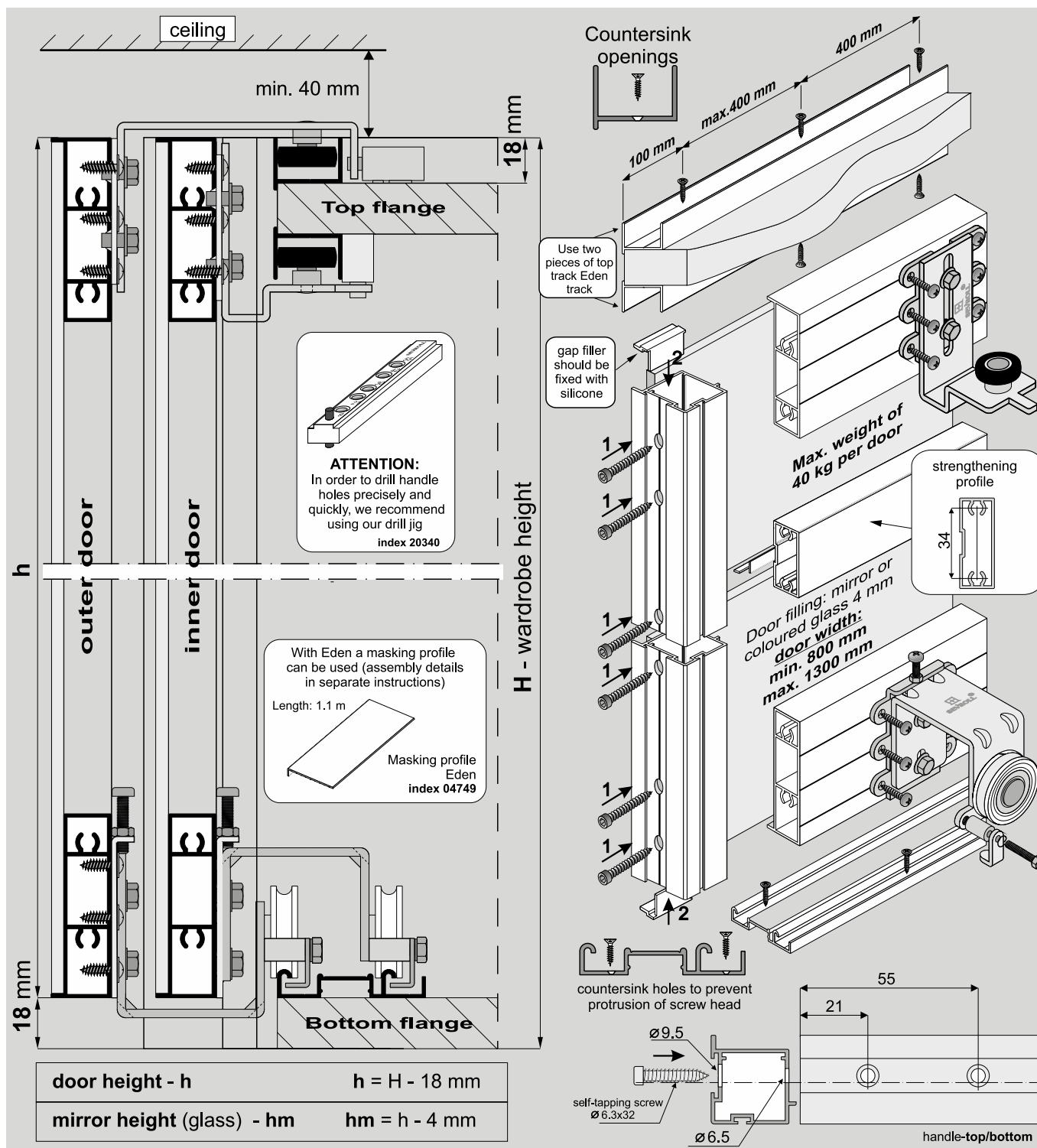

COMPONENTS

| | | | | | |
|---|--|--|---|---|---|
| Handle Pax L: 2.70 m, 3.00 m Anti-dust brush (inserted) 4.8 x 6 mm Textile door stop (inserted) 14 x 4 mm | Gap filler Pax 12 pcs | Horizontal profile Eden L: 1.70 m, 2.35 m, 3.00 m | Set for sliding door Eden - 2 door wings (inner and outer) x2 x2 x2 x4 x4 x2 screw 3.5x20 x 4 screw M4x20 x 4 self-tapping screw 3.9x13 x 48 spring washer 4 x 4 | Set for third door Eden - 1 inner door x2 x2 x1 x2 x2 x2 | Soft-close SV25 MINI (index: 20359-SV) or SV40 MINI (index: 20260-SV) x4 Central SV25 (20360-BL) or Central SV40 (20297-BL) x1 |
| Bottom track Gemini-Decor II L: 1.70 m, 2.35 m, 3.00 m, 4.05 m, 6.00 m 53 | Top track Eden L: 1.70 m, 2.35 m, 3.00 m, 6.00 m 24 | (A) Strengthening profile Spacer profile 04 (B) L: 3.00 m L: 3.00 m | | | |

You must remember to purchase self-tapping screws to construct each door (min. 8 screws per door).



door filling:
- mirror, coloured glass # 4 mm

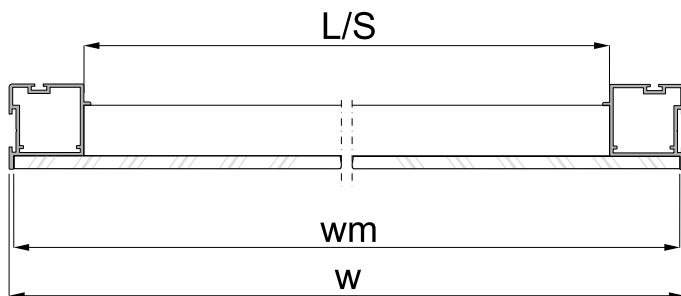
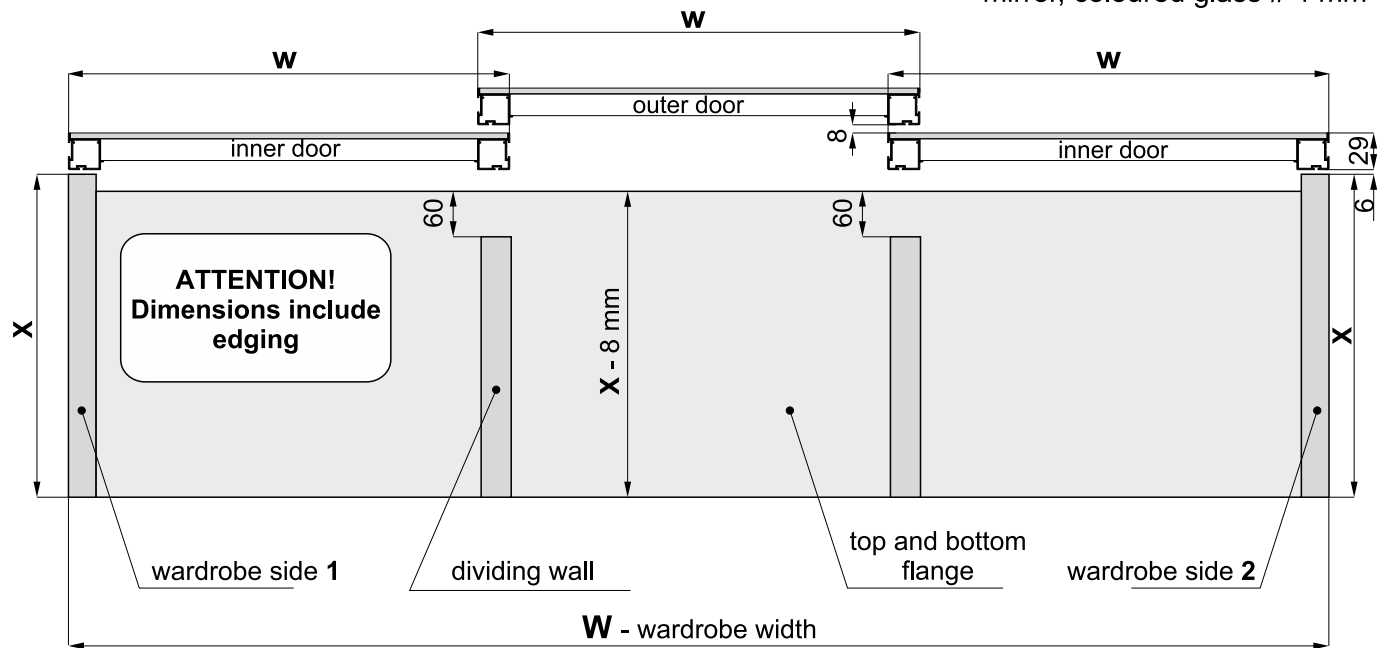

| | |
|------------------------------------|-------------------------------|
| Door width | $w = (W + 50 \text{ mm}) : 3$ |
| Mirror width (glass) | $w_m = w - 4 \text{ mm}$ |
| Horizontal profile Eden length - L | $L/S = w - 50 \text{ mm}$ |
| Strengthening profile length - S | |
| Spacer profile 04 length | $S + 46 \text{ mm}$ |

ATTENTION!

Rear mirror / coloured glass surface must be secured with safety backing foil (excluding glass surface glued with mirror adhesive).
The edges of glass must be polished.

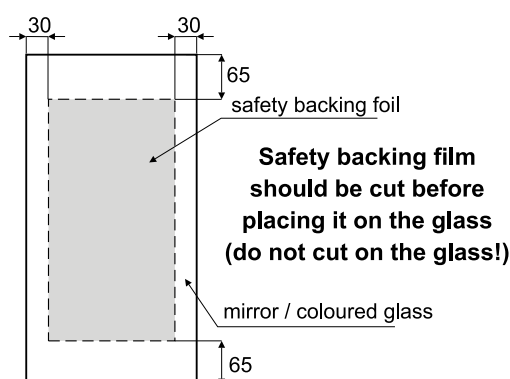

Installation method for fitting mirror or coloured glass 4 mm

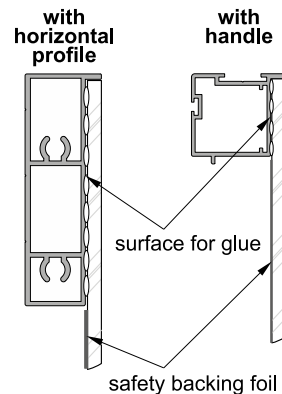

ATTENTION!
Due to the fact that no plinth is needed in system Eden, attention must be paid to the bottom flange being positioned level to the floor. Additionally, when using furniture slides, they should be placed along the whole length so that the bottom flange and bottom track does not bend.

with strengthening profile

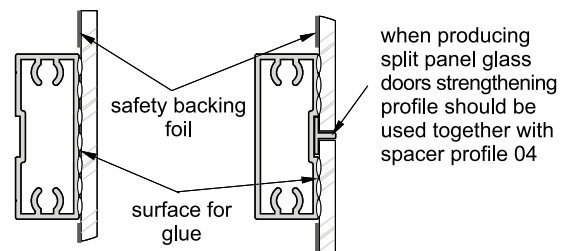

it is recommended that mirror / coloured glass is glued to aluminium profiles with specialist glass adhesive

The method of cutting spacer profile 04

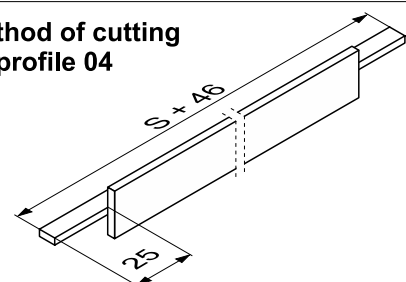

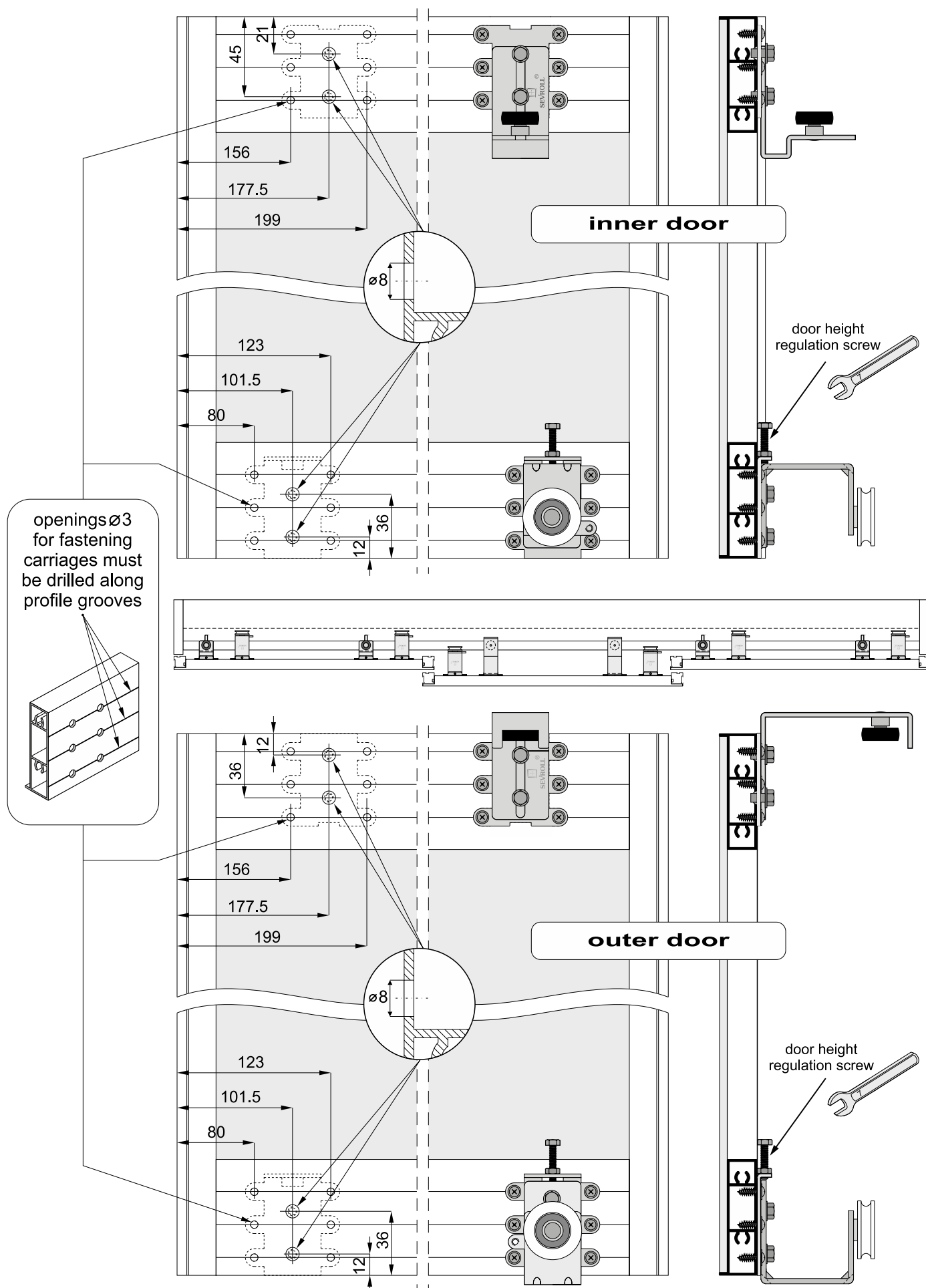



Inner door installation

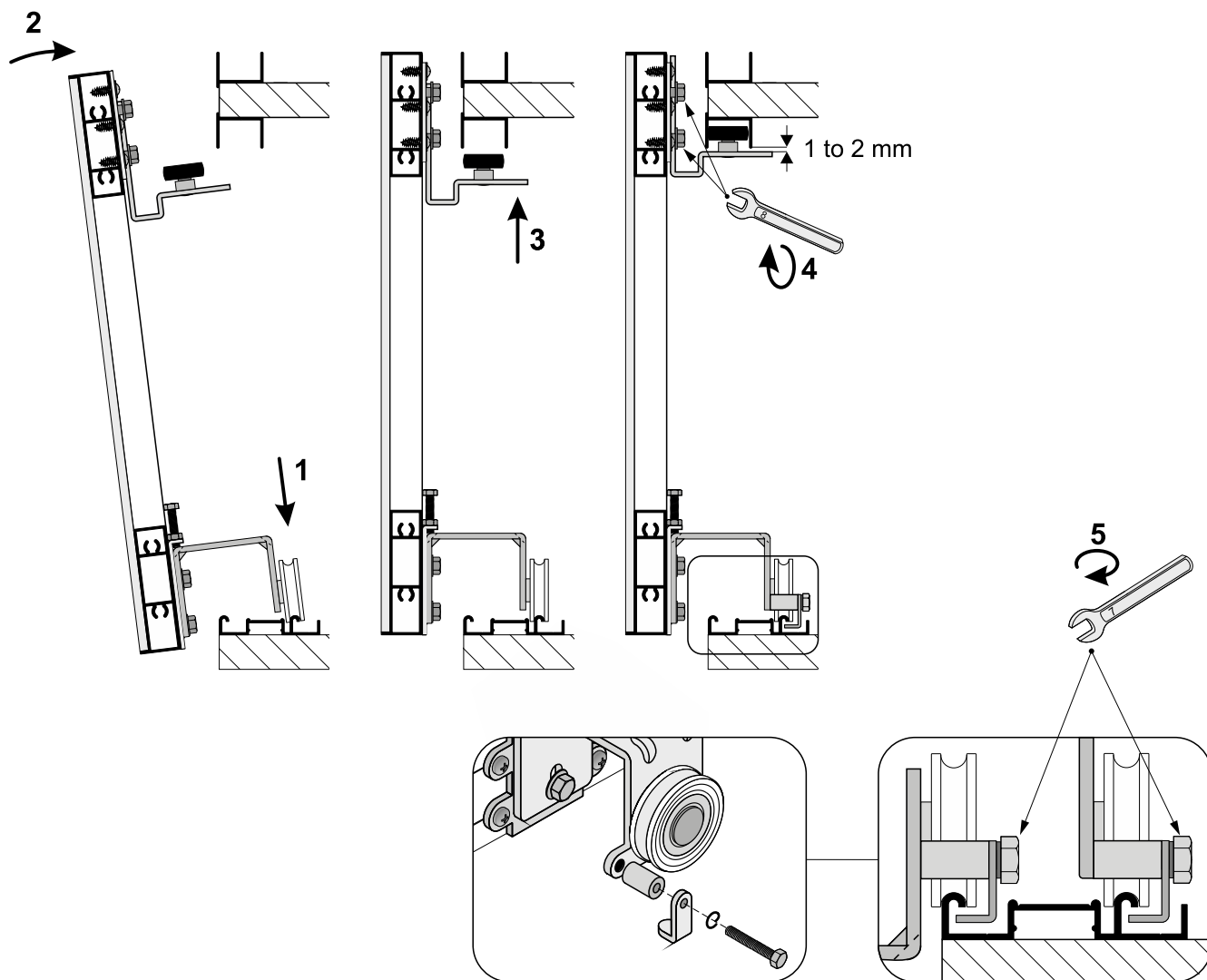

Outer door installation

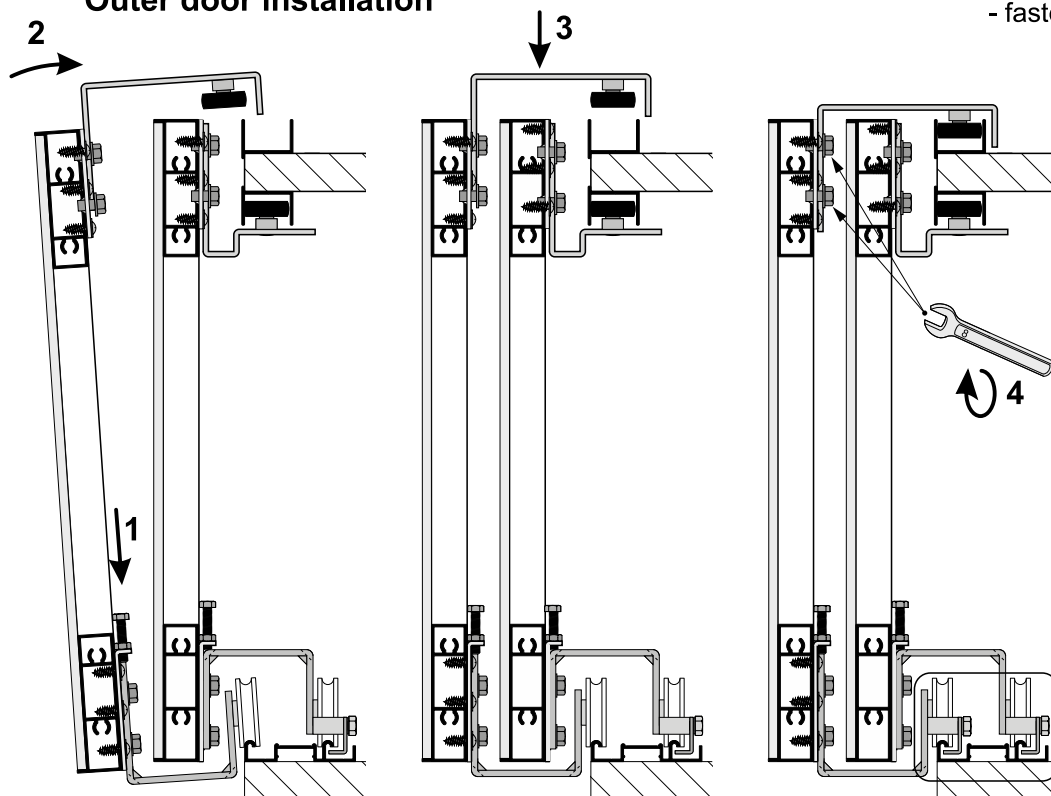

Soft-close installation

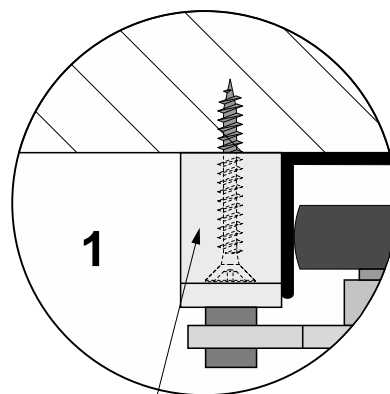

ATTENTION!
Remember to arm
the soft-closer prior
to door installation

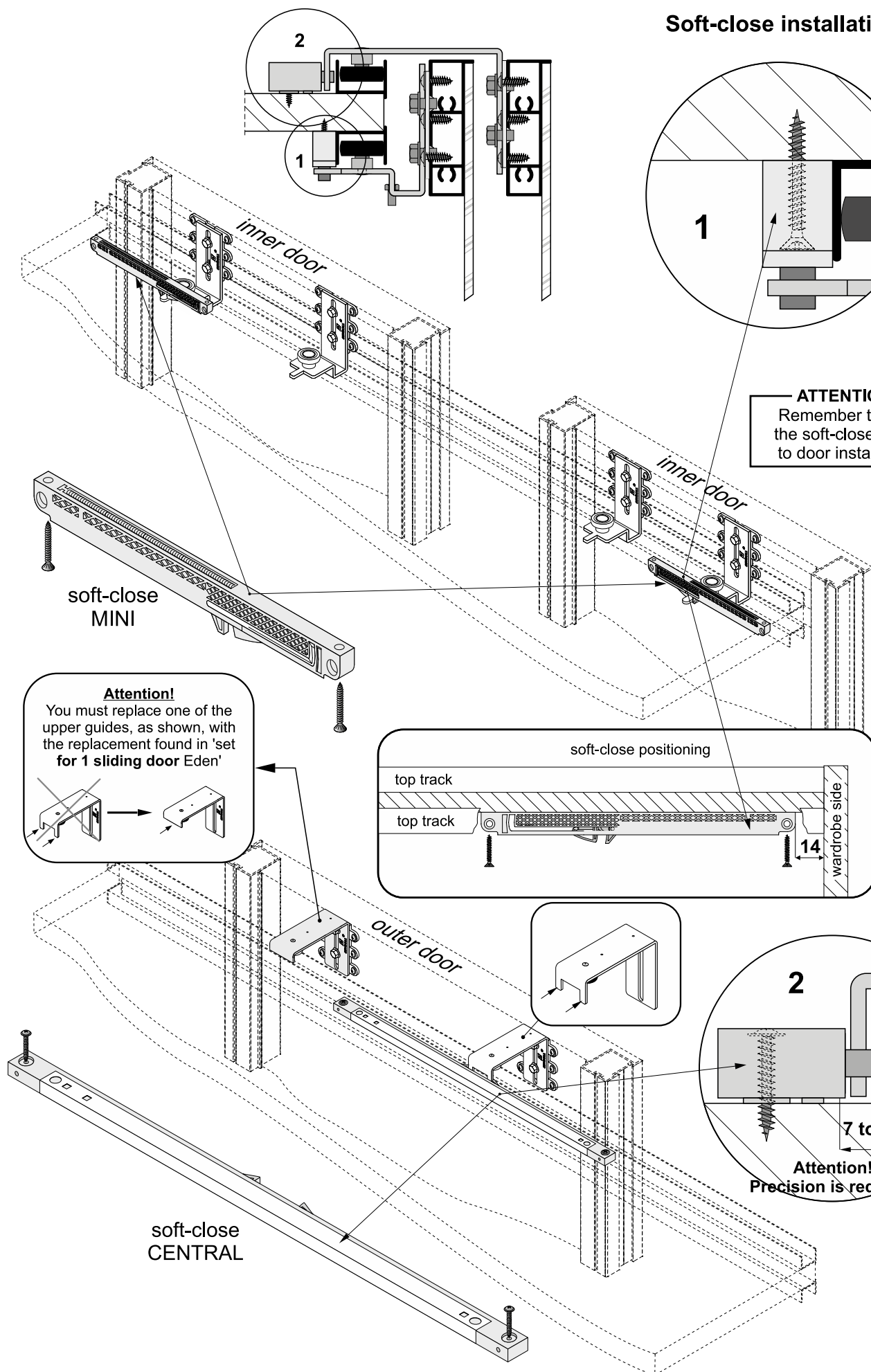

Attention!
You must replace one of the
upper guides, as shown, with
the replacement found in 'set
for 1 sliding door Eden'

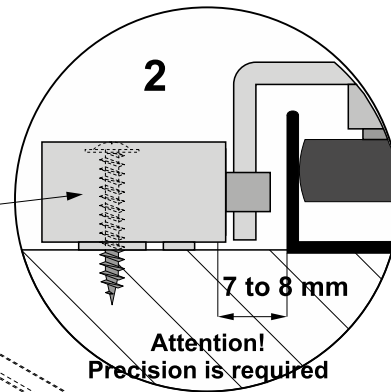
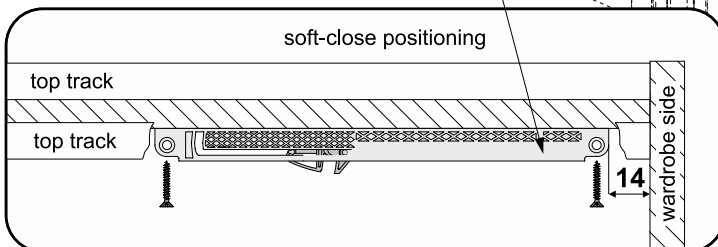

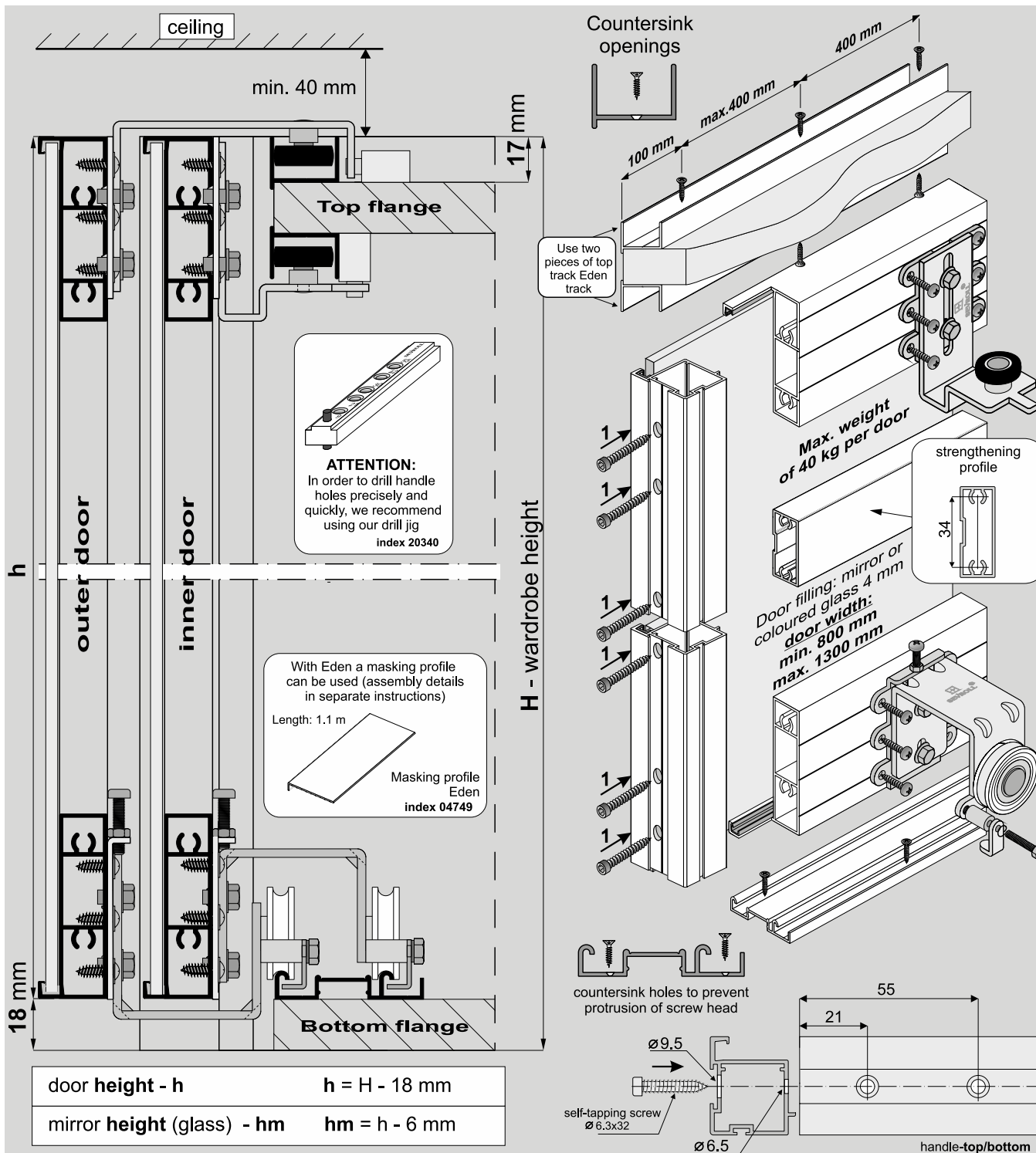

COMPONENTS

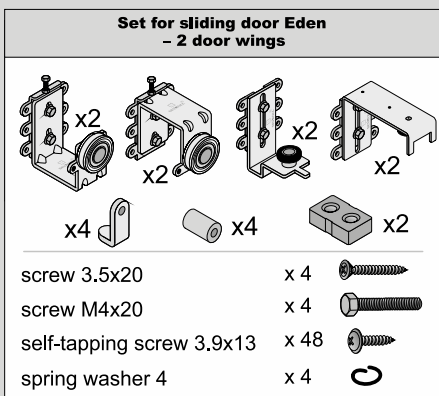
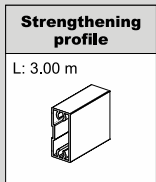
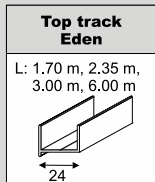
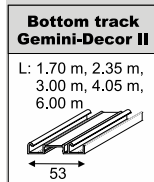
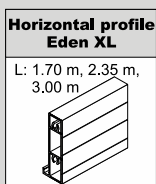
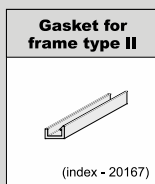

You must remember to purchase self-tapping screws to construct each door (min. 8 screws per door).

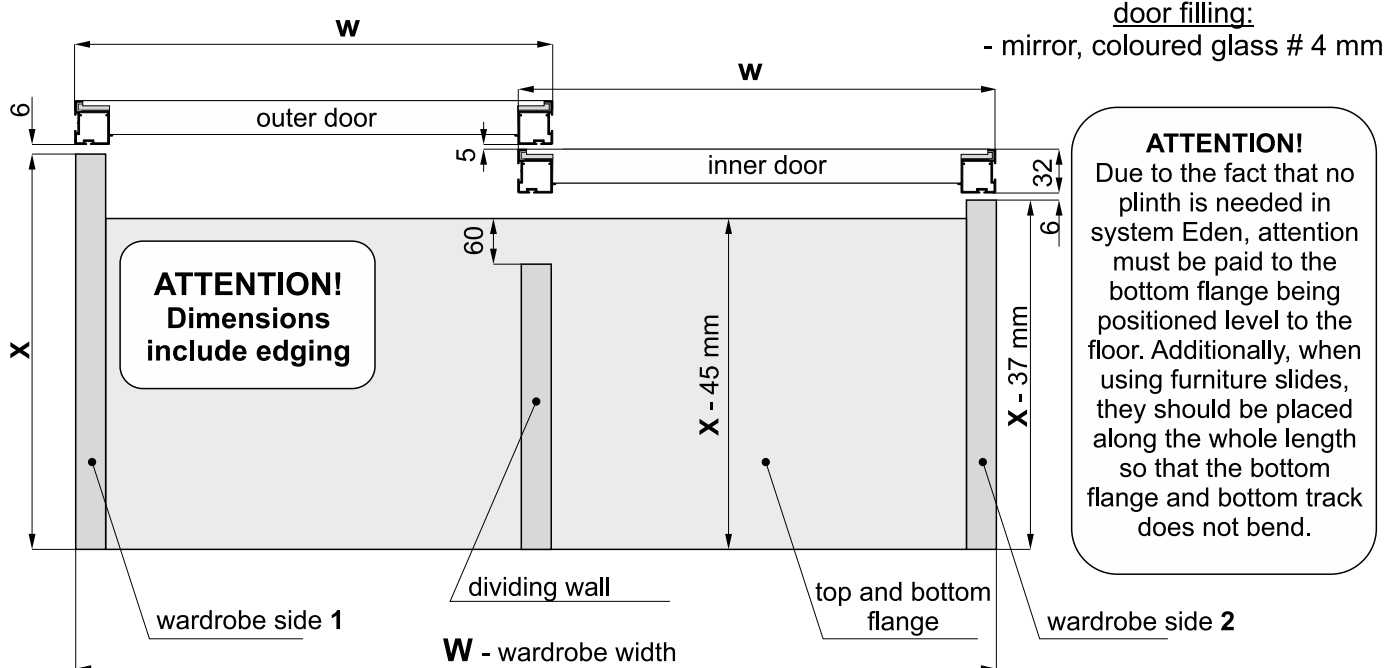

Installation method for fitting mirror or coloured glass 4 mm

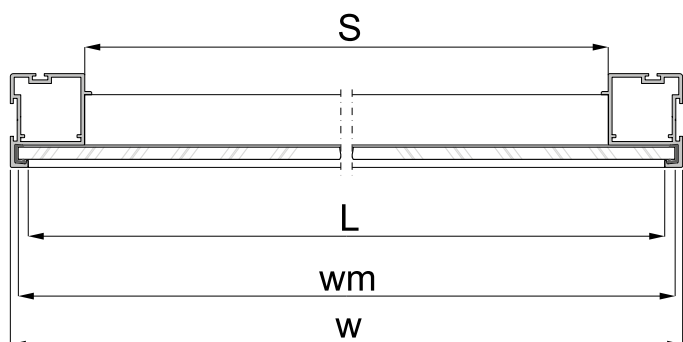

- with horizontal profile

- with handle

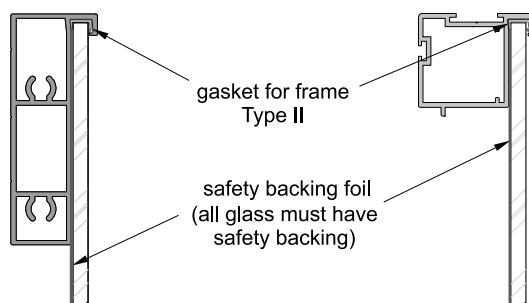

| | |
|-----------------------------------|-------------------------------|
| Door width | $w = (W + 25 \text{ mm}) : 2$ |
| Mirror width (glass) | $w_m = w - 6 \text{ mm}$ |
| Horizontal profile Eden XL length | $L = w - 12 \text{ mm}$ |
| Strengthening profile length | $S = w - 50 \text{ mm}$ |

ATTENTION!

Rear mirror / coloured glass surface must be secured with safety backing foil (excluding glass surface glued with mirror adhesive).
The edges of glass must be polished.

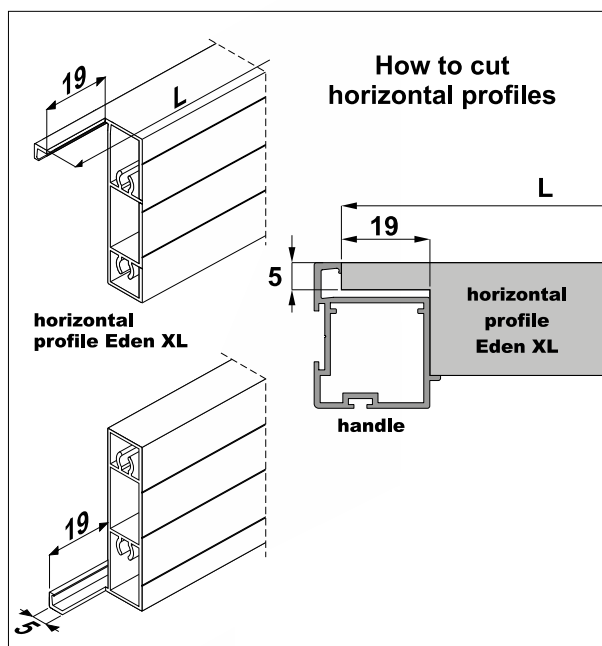

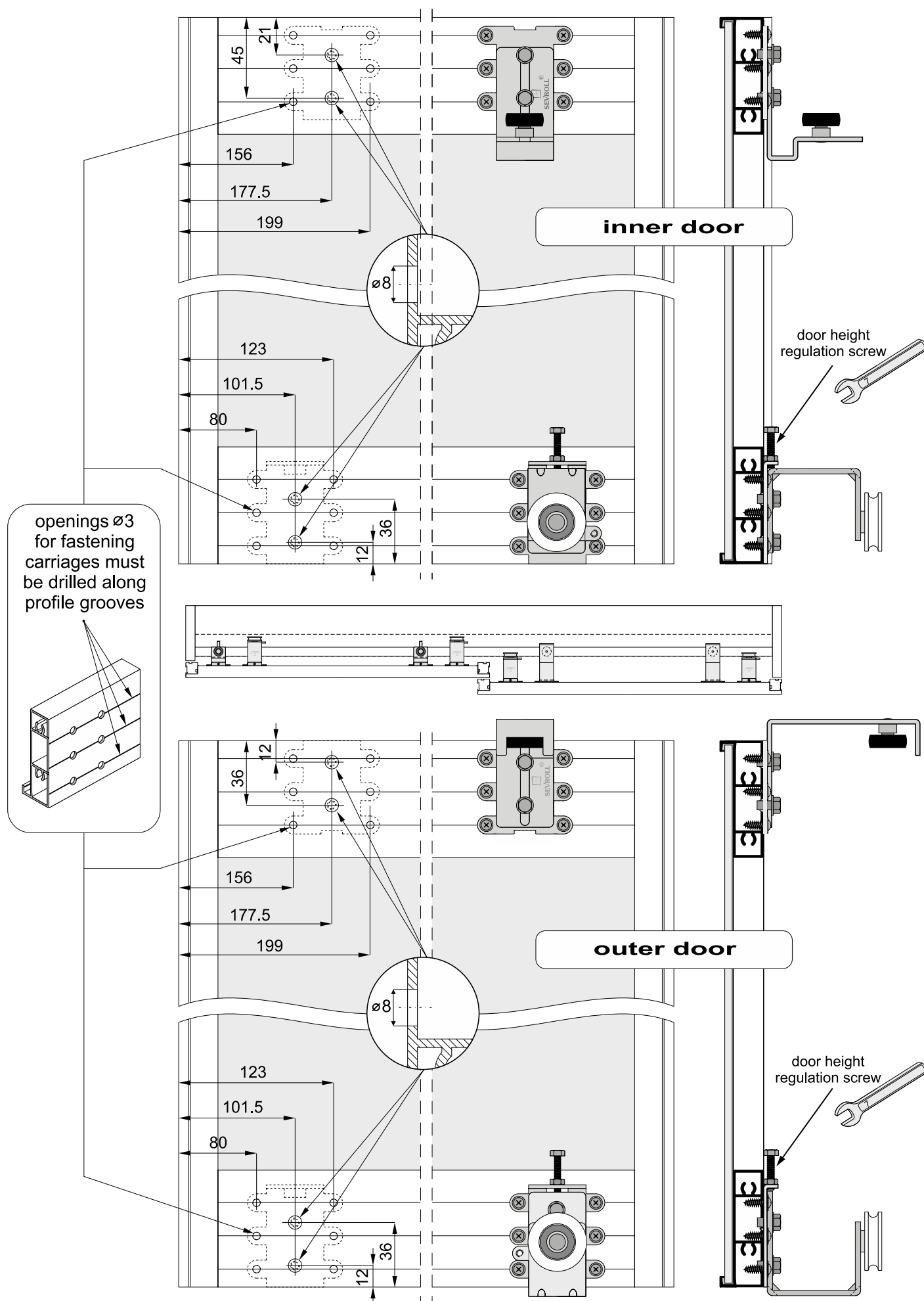



Inner door installation

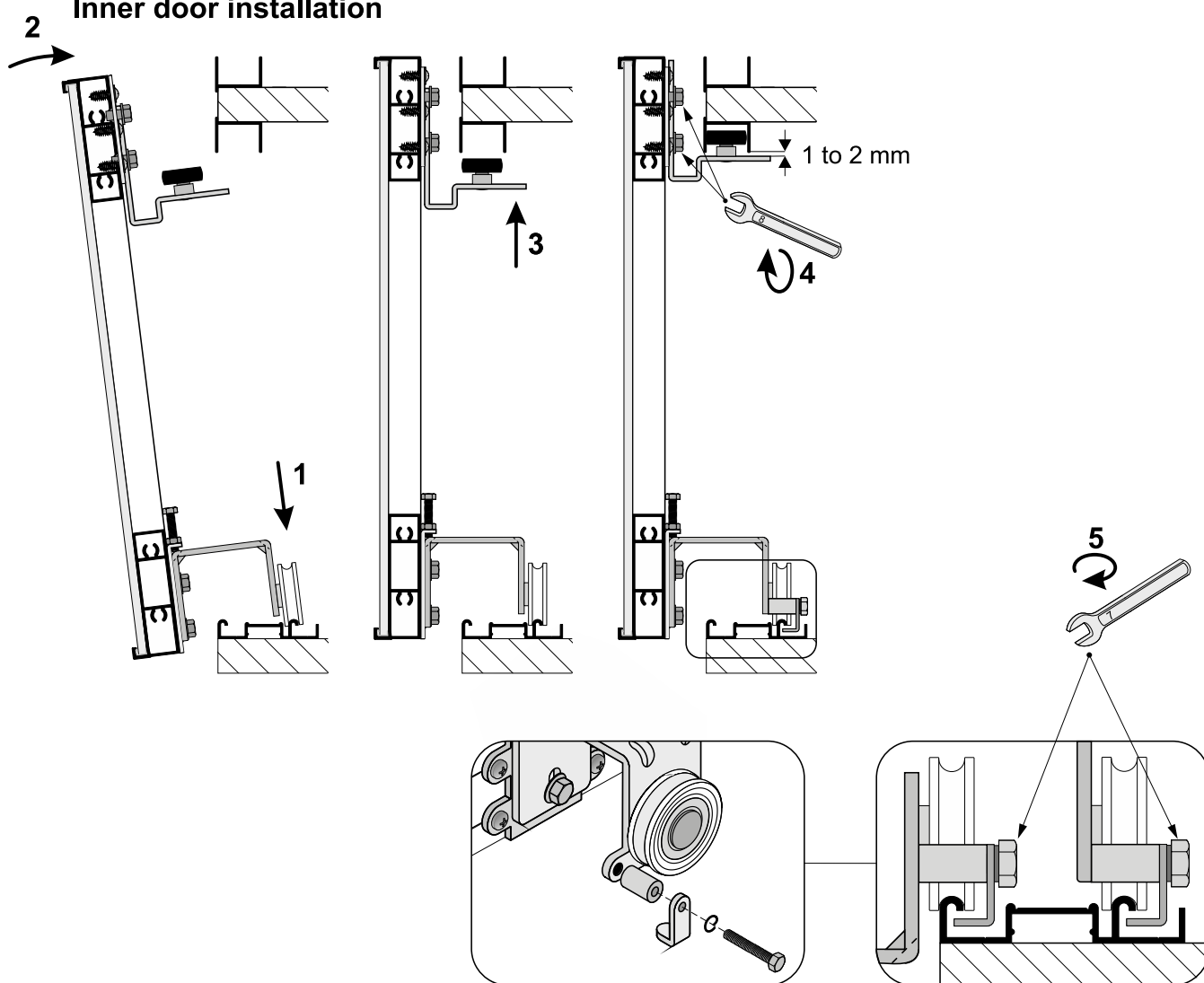

Outer door installation

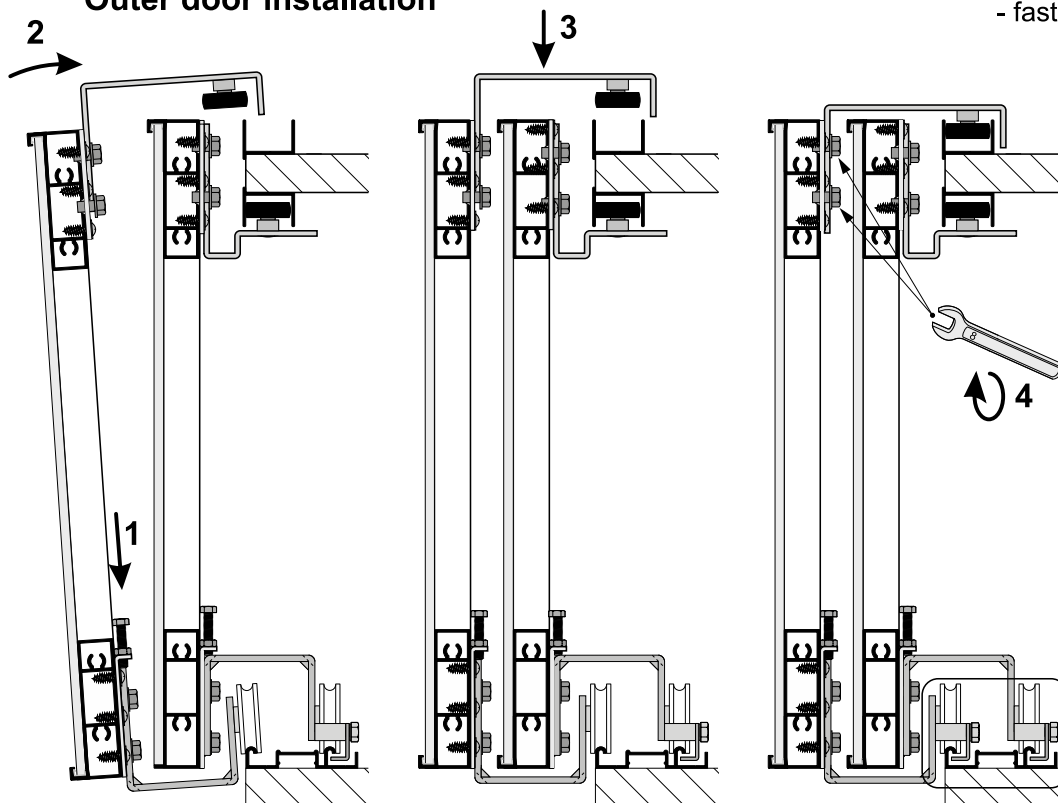



Soft-close installation

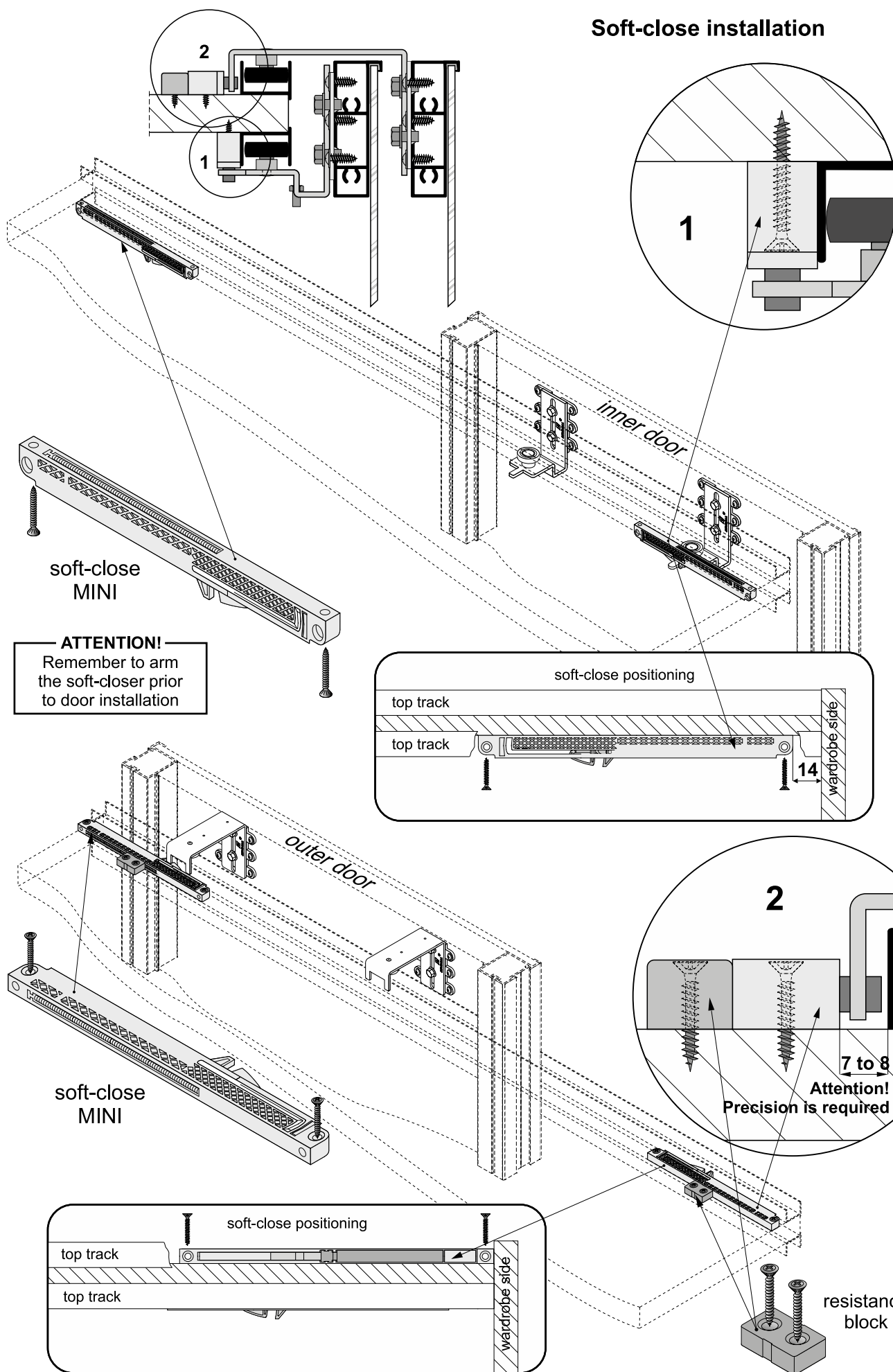

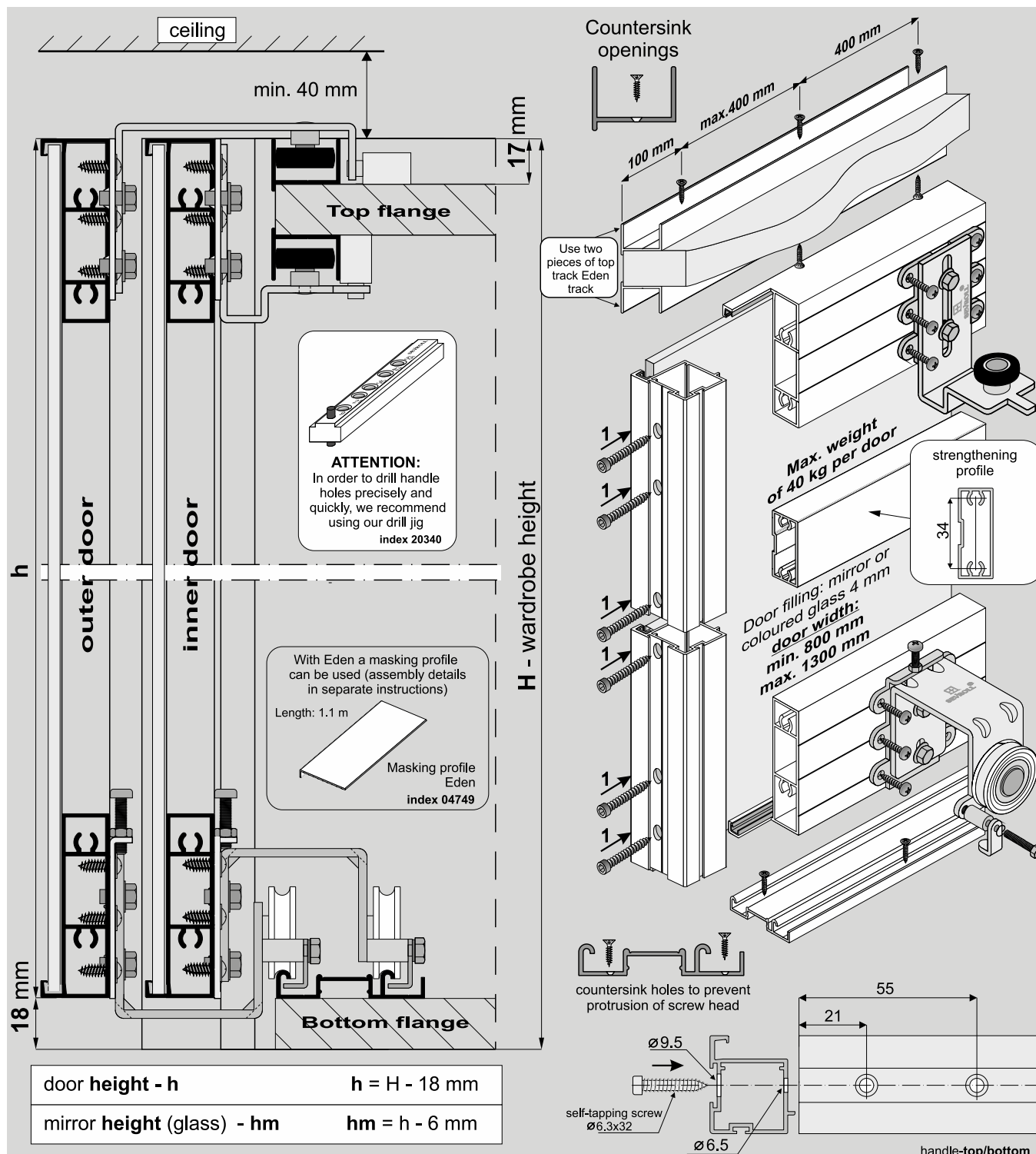

COMPONENTS

| | | | | |
|--|--|--|---|--|
| Handle Pax XL L: 2.70 m, 3.00 m Anti-dust brush (inserted) 4,8 x 6 mm Textile door stop (inserted) 14 x 4 mm | Gasket for frame Type II (index - 20167) | Horizontal profile Eden XL L: 1.70 m, 2.35 m, 3.00 m | Set for sliding door Eden - 2 door wings (inner and outer) x4 x4 x2 x2 x2 x4 x4 x48 x4 | Set for third door Eden - 1 inner door x2 x2 x1 x24 x2 x2 x2 |
| Bottom track Gemini-Decor II L: 1.70 m, 2.35 m, 3.00 m, 4.05 m, 6.00 m 53 | Top track Eden L: 1.70 m, 2.35 m, 3.00 m, 6.00 m 24 | Strengthening profile L: 3.00 m | Soft-close SV25 MINI (index: 20359-SV) or SV40 MINI (index: 20260-SV) x4 Central SV25 (20360-BL) or Central SV40 (20297-BL) x1 | |

You must remember to purchase self-tapping screws to construct each door (min. 8 screws per door).



door filling:
- mirror, coloured glass # 4 mm

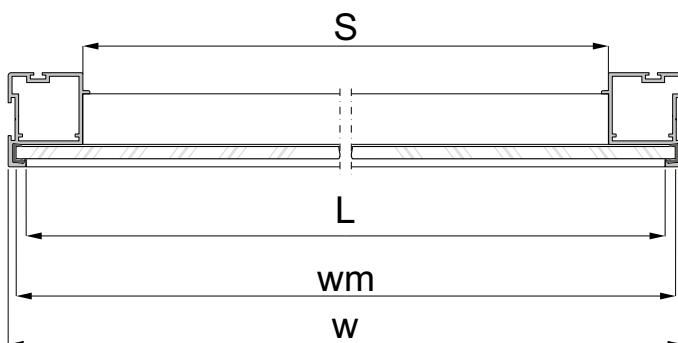
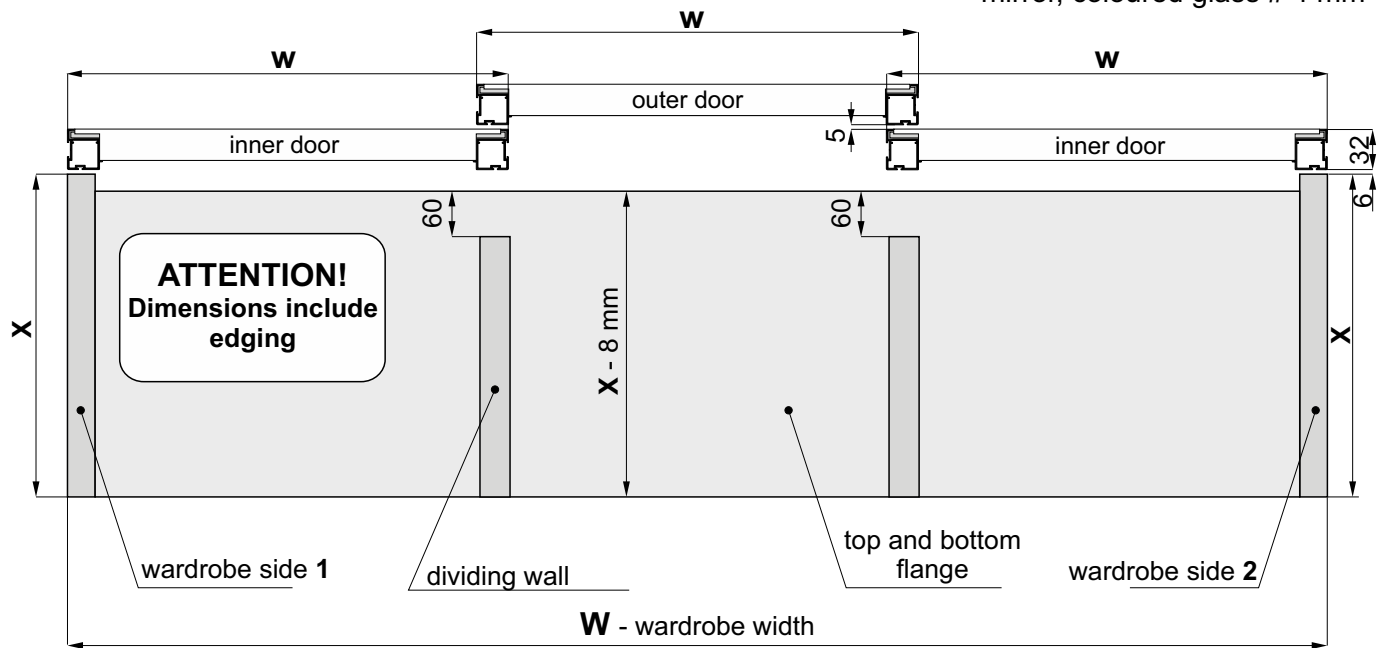

Installation method for fitting mirror or coloured glass 4 mm

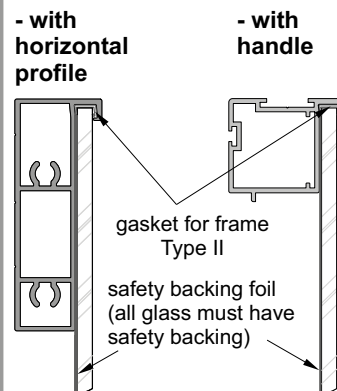

ATTENTION!

Due to the fact that no plinth is needed in system Eden, attention must be paid to the bottom flange being positioned level to the floor. Additionally, when using furniture slides, they should be placed along the whole length so that the bottom flange and bottom track does not bend.

| | |
|-----------------------------------|-------------------------------|
| Door width | $w = (W + 50 \text{ mm}) : 3$ |
| Mirror width (glass) | $w_m = w - 6 \text{ mm}$ |
| Horizontal profile length Eden XL | $L = w - 12 \text{ mm}$ |
| Strengthening profile length | $S = w - 50 \text{ mm}$ |

ATTENTION!

Rear mirror / coloured glass surface must be secured with safety backing foil (excluding glass surface glued with mirror adhesive).
The edges of glass must be polished.

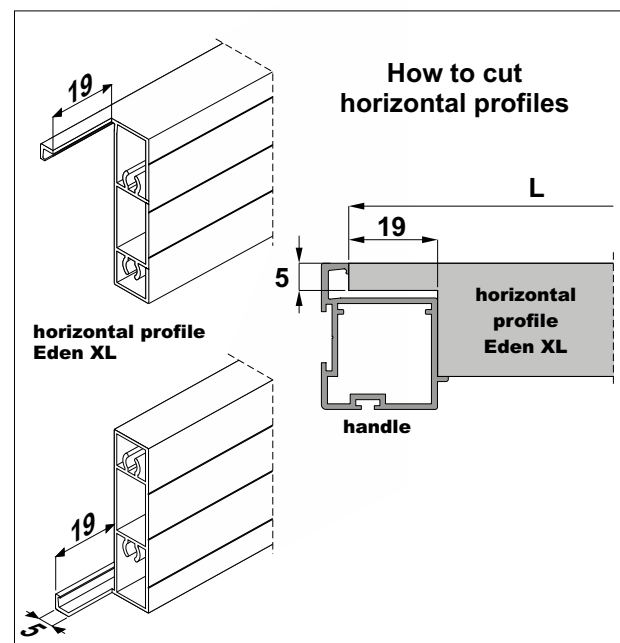

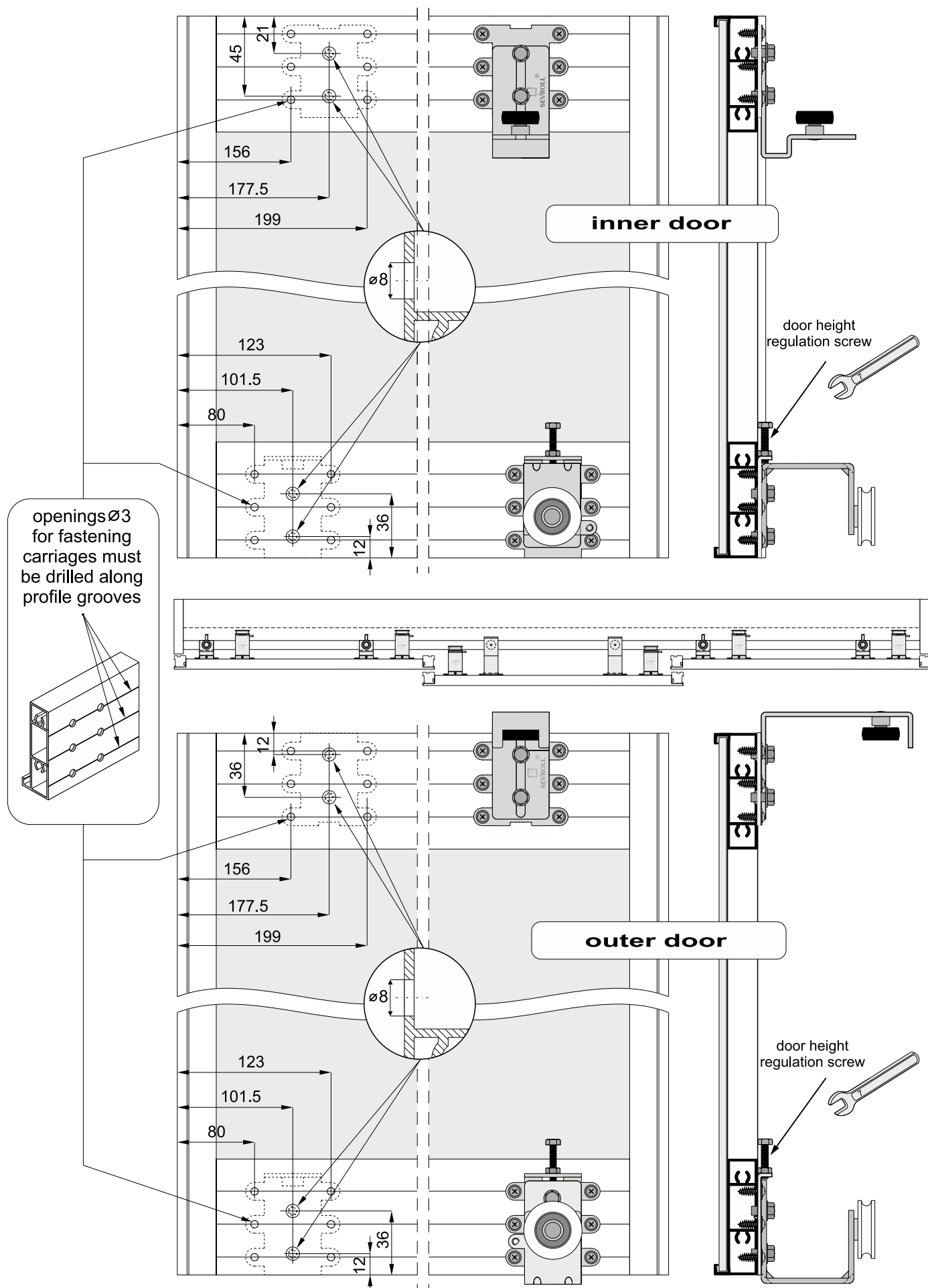



Inner door installation

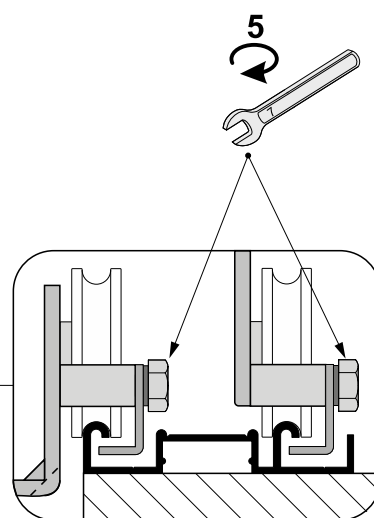
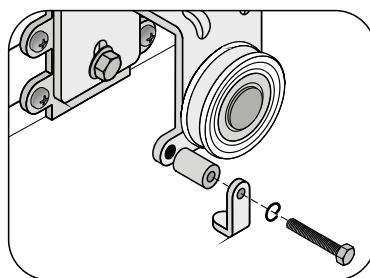
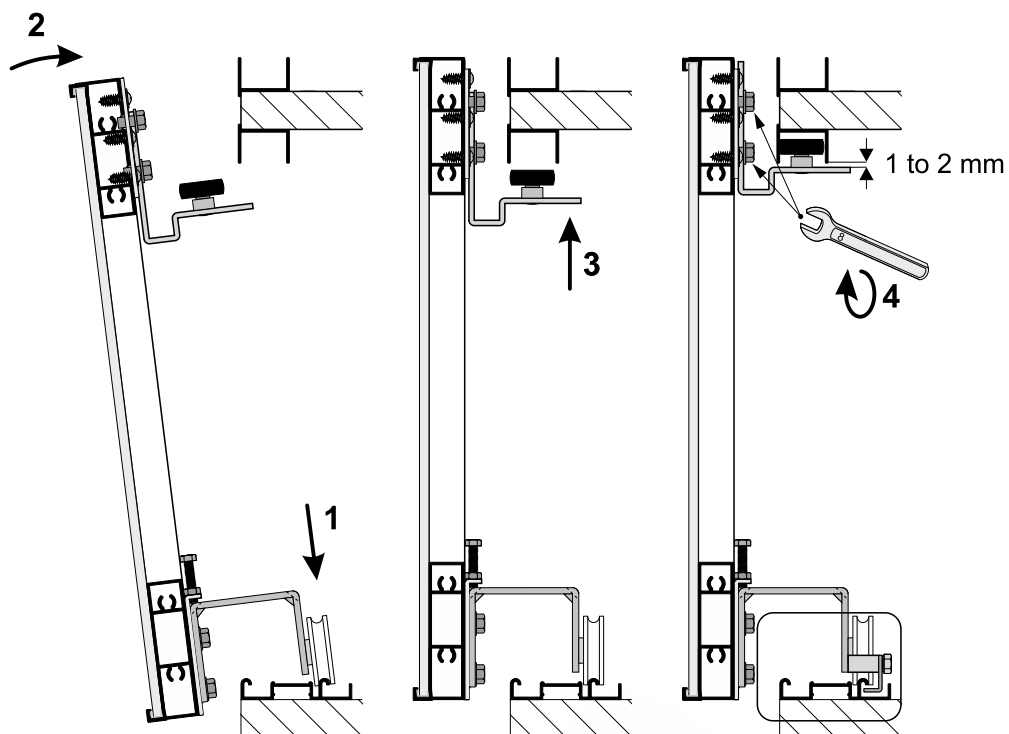

securing catch
- fasten after door assembly

Outer door installation

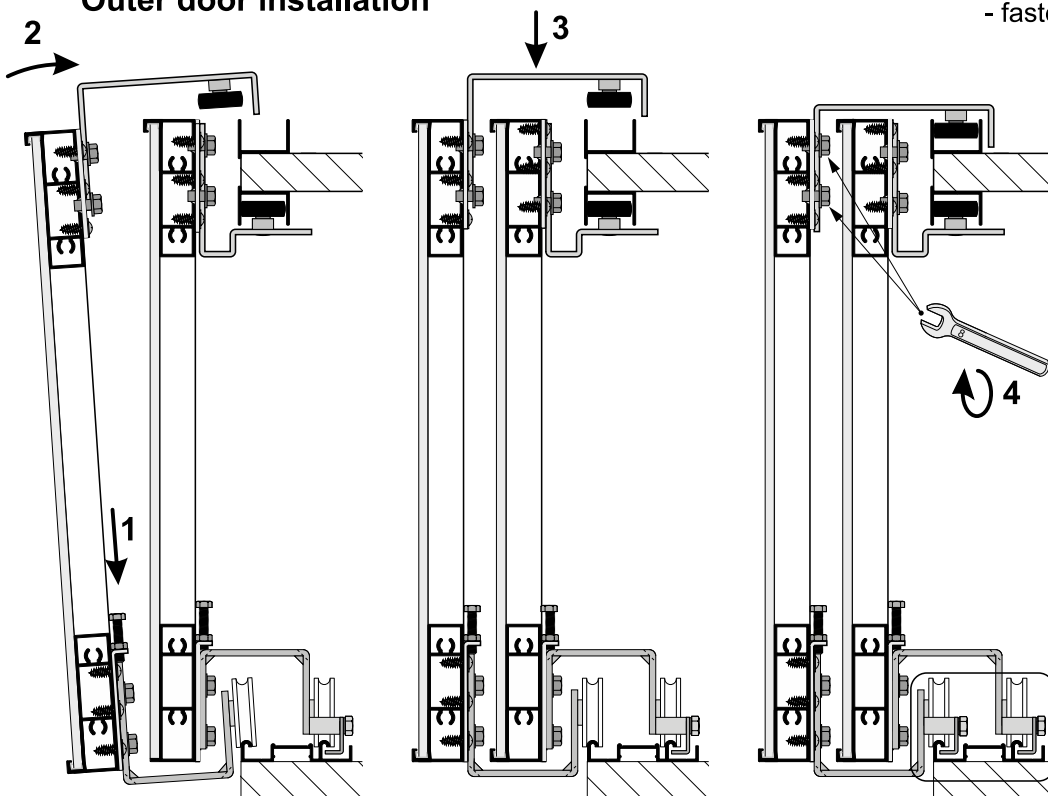

Soft-close installation

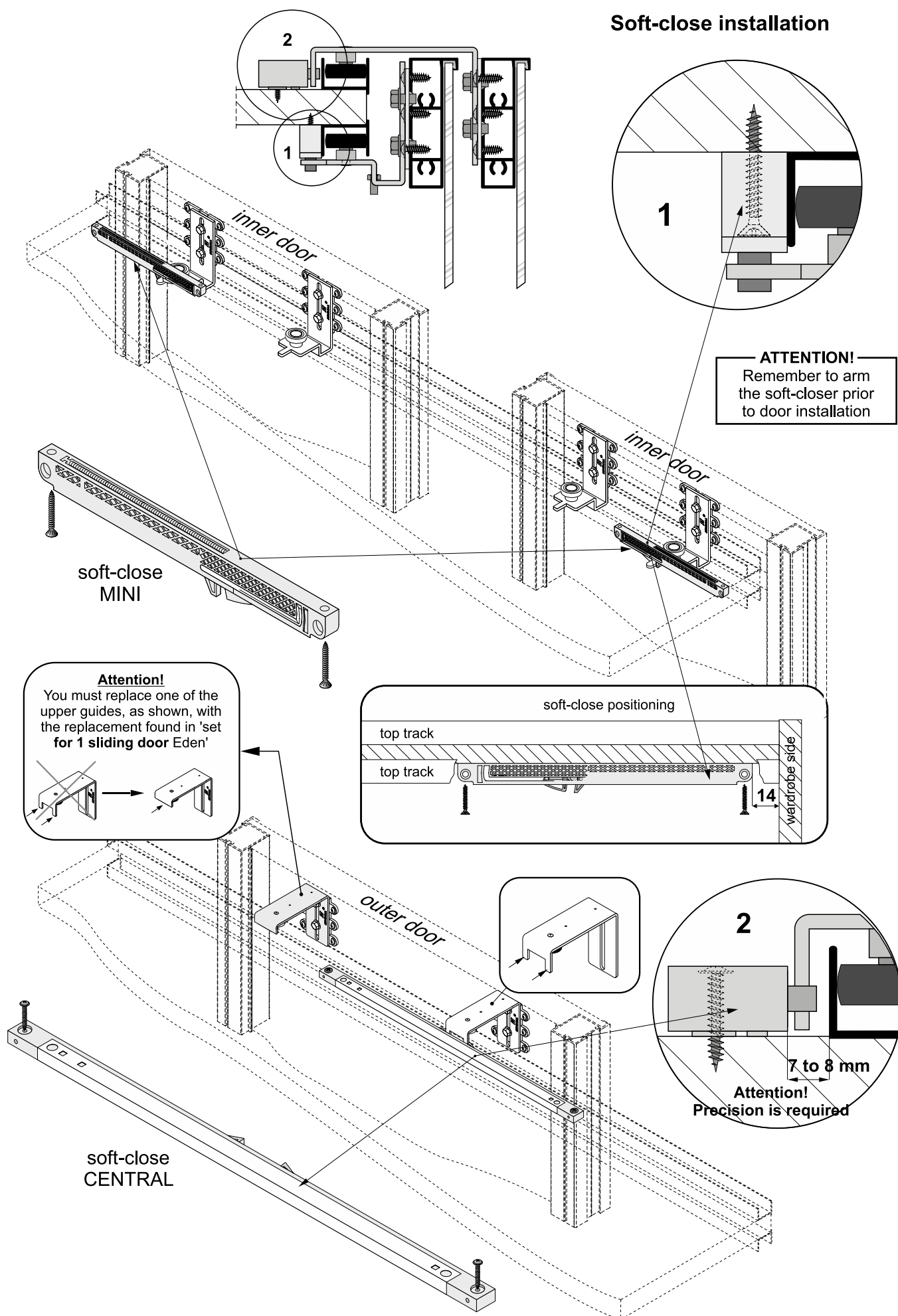



installation method for masking profile EDEN

